

Dell Vostro 460

Setup and Features Information

Front and Back View

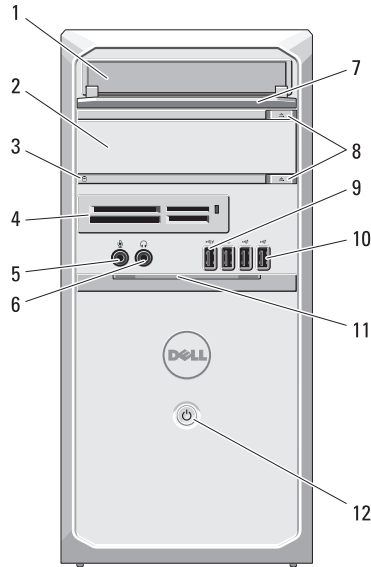

About Warnings



WARNING: A WARNING indicates a potential for property damage, personal injury, or death.

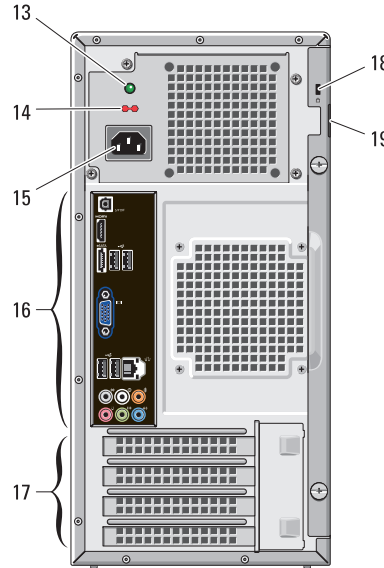

- 1 optical drive
- 2 optical drive (optional)
- 3 hard-drive activity light
- 4 media-card reader (optional)
- 5 microphone connector
- 6 headphone connector
- 7 drive bay front panel (open)
- 8 optical-drive eject buttons (2)
- 9 powered USB 2.0 connector
- 10 USB 2.0 connectors (3)
- 11 front panel door (open)
- 12 power button
- 13 power supply diagnostic light
- 14 voltage selector switch
- 15 power connector
- 16 back panel connectors
- 17 expansion card slots (4)
- 18 security cable slot
- 19 padlock slot



NOTE: The second optical drive eject button is functional only if a second optical drive is installed in the computer.



Regulatory Model: D10M

Regulatory Type: D10M001

December 2010



ORHVPDA00

Back Panel

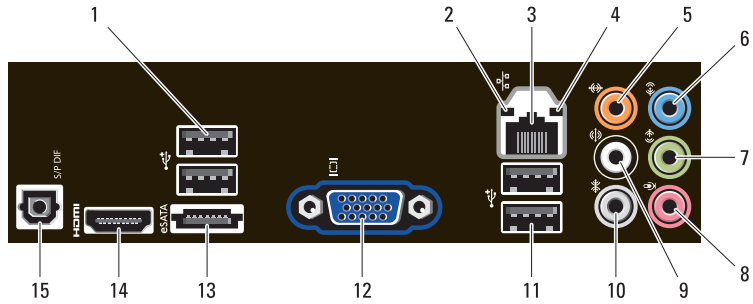

- 1 USB 2.0 connectors (2)
- 2 link integrity light
- 3 network adapter connector
- 4 network activity light
- 5 center/subwoofer connector
- 6 line-in connector
- 7 front L/R line-out connector
- 8 microphone connector
- 9 rear L/R speaker connector
- 10 side L/R surround connector
- 11 USB 2.0 connectors (2)
- 12 VGA connector
- 13 eSATA connector
- 14 HDMI connector
- 15 S/PDIF connector

Quick Setup

⚠ WARNING: Before you begin any of the procedures in this section, read the safety information that shipped with your computer. For additional best practices information, see www.dell.com/regulatory_compliance.

✍ NOTE: Some devices may not be included if you did not order them.

✍ NOTE: Some cables may not be shipped with your computer.

1 Connect the network cable (optional).

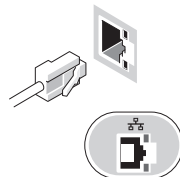

2 Connect the telephone cable (optional).

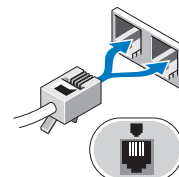

3 If you purchased the optional discrete graphics card, connect the display to the connector on the discrete graphics card. Otherwise, connect the display using either the integrated VGA or HDMI connector. Connect the monitor using only one of the following cables.

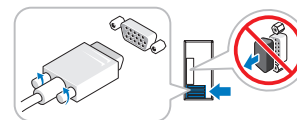
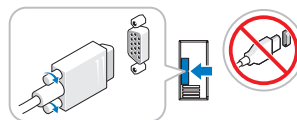
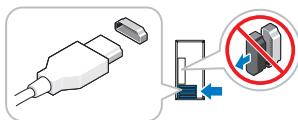

4 Connect the USB keyboard or mouse (optional).

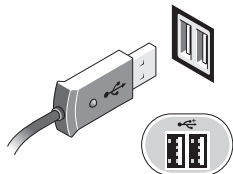

5 Connect the power cable(s).

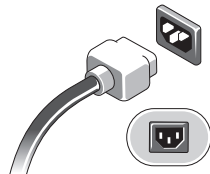

6 Press the power buttons on the monitor and the computer.

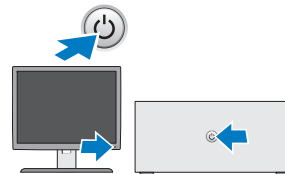
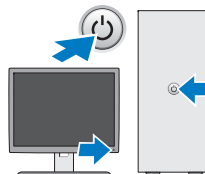

Specifications



NOTE: The following specifications are only those required by law to ship with your computer. For a complete and current listing of the specifications for your computer, go to support.dell.com.

System Information

Chipset	Intel H67
Processor	Intel Core i3 series Intel Core i5 series Intel Core i7 series

Video

Video type:	
Integrated	Intel HD graphics 2000
Discrete	PCI-E x16 graphics card <ul style="list-style-type: none">• NVIDIA GeForce GTX460• NVIDIA M114A• NVIDIA M207 GT420• AMD Radeon HD 5450• AMD Radeon HD 5670
Video memory (discrete)	256 MB, 512 MB, and 1024 MB

Memory

Memory module connector	four DIMM slots
Memory module capacity	1 GB, 2 GB, or 4 GB
Memory type	1333 MHz DDR3
Minimum memory	1 GB
Maximum memory	16 GB

Drives

Externally accessible:

3.5 inch drive bays	one
5.25 inch drive bays	two

Internally accessible:

3.5 inch SATA drive bays	two
--------------------------	-----

Control Lights and Diagnostic Lights

Power button light	White light — Solid white light indicates power-on state; blinking white light indicates sleep state of the computer. Amber light — Solid amber light when the computer does not start indicates a problem with the system board or power supply. Blinking amber light indicates a problem with the system board.
Drive activity light	White light — Blinking white light indicates that the computer is reading data from or writing data to the hard drive.
Link integrity light	Green or Amber light — A good connection exists between the network and the computer. Off (no light) — The computer is not detecting a physical connection to the network.
Diagnostic lights	For information on the diagnostic lights, see the <i>Service Manual</i> available on the Dell Support website at support.dell.com/manuals .

Power

Wattage	350 W
Voltage	100 V – 127 V/200 V – 240 V, 50 Hz – 60 Hz, 10 A/5 A
Maximum heat dissipation	1837 BTUs/h (350 W power supply)

NOTE: Heat dissipation is calculated by using the power supply wattage rating.

NOTE: See the safety information that shipped with your computer for important voltage–setting information.

Coin-cell battery	3 V CR2032 lithium coin cell
-------------------	------------------------------

Physical

Height	
Without base	360.00 mm (14.17 inches)
With base	362.90 mm (14.29 inches)
Width	175.00 mm (6.89 inches)
Depth	445.00 mm (17.52 inches)
Weight	9.66 kg – 11.22 kg (21.30 lb – 24.74 lb)

Environmental

Temperature:

Operating 10 °C to 35 °C (50 °F to 95 °F)

Non-operating -40 °C to 65 °C (-40 °F to 149 °F)

Relative humidity 20 % to 80 % (noncondensing)

Altitude:

Operating -15.2 m to 3048 m (-50 ft to 10,000 ft)

Non-operating -15.2 m to 10,668 m (-50 ft to 35,000 ft)

Airborne contaminant level G2 or lower as defined by ISA-S71.04-1985

Finding More Information and Resources

See the safety and regulatory publications that shipped with your computer and the regulatory compliance website at

www.dell.com/regulatory_compliance for more information on:

- Safety best practices
- Warranty
- Terms and Conditions
- Regulatory certification
- Ergonomics
- End User License Agreement

Information in this publication is subject to change without notice.

© 2010 Dell Inc. All rights reserved. Printed in the U.S.A.

Reproduction of these materials in any manner whatsoever without the written permission of Dell Inc. is strictly forbidden.

Trademarks used in this text: Dell™, the DELL logo, and Vostro™ are trademarks of Dell Inc.; Intel® is a registered trademark and Core™ is a trademark of Intel Corporation in the U.S. and other countries.

Other trademarks and trade names may be used in this publication to refer to either the entities claiming the marks and names or their products.

Dell Inc. disclaims any proprietary interest in trademarks and trade names other than its own.

Free Manuals Download Website

<http://myh66.com>

<http://usermanuals.us>

<http://www.somanuals.com>

<http://www.4manuals.cc>

<http://www.manual-lib.com>

<http://www.404manual.com>

<http://www.luxmanual.com>

<http://aubethermostatmanual.com>

Golf course search by state

<http://golfingnear.com>

Email search by domain

<http://emailbydomain.com>

Auto manuals search

<http://auto.somanuals.com>

TV manuals search

<http://tv.somanuals.com>