

WARNING – FCC Regulations state that any unauthorized changes or modifications to this equipment not expressly approved by the manufacturer could void the user's authority to operate this equipment.

Note: This equipment has been tested and found to comply with the limits for a Class B digital device, pursuant to Part 15 of the FCC Rules. These limits are designed to provide reasonable protection against harmful interference in a residential installation. This equipment generates, uses, and can radiate radio frequency energy and, if not installed and used in accordance with the instructions, may cause harmful interference to radio communications. However, there is no guarantee that interference will not occur in a particular installation. If this equipment does cause harmful interference to radio or television reception, which can be determined by turning the equipment off and on, the user is encouraged to try to correct the interference by one or more of the following measures:

- Reorient or relocate the receiving antenna.
- Increase the separation between the equipment and receiver.
- Connect the equipment into an outlet on a circuit different from that to which the receiver is connected.
- Consult the dealer or an experienced radio/TV technician for help.

## SHARP CORPORATION

PRINTED IN CHINA / IMPRESO EN CHINA  
04GT(TINSZ074EHZZ)

## OPERATIONAL NOTES

- To insure trouble-free operation of your SHARP calculator, we recommend the following:
- The calculator should be kept in areas free from extreme temperature changes, moisture, and dust.
  - A soft, dry cloth should be used to clean the calculator. Do not use solvents or a wet cloth.
  - Since this product is not waterproof, do not use it or store it where fluids, for example water, can splash onto it. Raindrops, water spray, juice, coffee, steam, perspiration, etc. will also cause malfunction.
  - If service should be required, use only a SHARP servicing dealer, a SHARP approved service facility or SHARP repair service.
  - Do not operate the unit with the battery insulation sheet attached. The battery insulation sheet prevents the memory protection battery from wearing, and is found on the back of the unit. Operating with the battery insulation sheet attached may result to loss of information such as date and time, conversion rate, and tax/discount rate if the AC power plug is accidentally pulled out from the wall socket.
  - Do not wind the AC cord around the body or otherwise forcibly bend or twist it.

SHARP will not be liable nor responsible for any incidental or consequential economic or property damage caused by misuse and/or malfunctions of this product and its peripherals, unless such liability is acknowledged by law.

## USING THE CALCULATOR FOR THE FIRST TIME

First, pull out the insulation sheet for the memory protection battery (installed for retaining the date/time, conversion rate, and tax/discount rate information). Reset the calculator to initialize the unit's state, then adjust the date and time.

## Removing the insulation sheet, and resetting

- Pull out the insulation sheet for the memory protection battery.

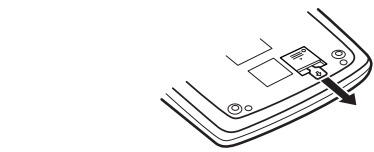

- Press the RESET switch located on the back of the unit. (See "RESETTING THE UNIT")  
\* The clock starts, indicating the current date and time as January 1, 2005, 12:00:00 a.m.

## Adjusting date and time

Example: When the date is September 15, 2004, and the time is 3:38 p.m.

Operation	Display
RATE GT • SET 9 [.] 15 [.] 2004 [M]	9-15-2004
15 [.] 38 [M]	3-38 00 P
[M]	0.

(see "GRAND TOTAL / RATESSETTING MODE SELECTOR")

\* When the adjustment is complete, the clock starts at 3:38:00 p.m.

## OPERATING CONTROLS

ON  
OFF • P P•C  
POWER SWITCH; PRINT / ITEM COUNT MODE SELECTOR:

"OFF": Power off.  
"•": Power ON. Set to the non-print mode.  
"P": Power ON. Set to the print mode.  
"P•C": Power ON. Set to the print and item count mode.

- The counter will count the number of times that the [M] key has been pressed in addition.  
Note: • Each time the [M] key is used in subtraction, 1 will be subtracted from the count.
    - The count is printed when the calculated result is obtained.
    - Pressing of the [X], [X], [÷], [AVG] or [MU] key clears the counter.
  - When the grand total/rate setting mode selector is in the ON position (GT), the counter will count the number of times that the calculation results have been stored in the grand total memory. To print and clear the count, press the [GT] key.
  - The memory item counter will count the number of times that the [M] key has been pressed in the addition.  
Note: • Each time the [M] key is used in the subtraction, 1 will be subtracted from the count.
    - The count is printed when the memory is recalled.
    - Pressing of the [M] key clears the counter.
- Note: The counter has a maximum capacity of 3 digits (up to ±999). If the count exceeds the maximum, the counter will recount from zero.

## F 6 3 2 1 0

DECIMAL SELECTOR:  
Presses the number of decimal places in the answer. In the "F" position, the answer is displayed in the floating decimal system.

## K • A

CONSTANT/ADD MODE SELECTOR:  
"K": The following constant functions will be performed:

**Multiplication:**  
The calculator will automatically remember the first number entered (the multiplicand) and [X] instruction.

**Division:**  
The calculator will automatically remember the second number entered (the divisor) and [÷] instruction.

"•": Neutral  
"A": Use of the Add mode permits addition and subtraction of numbers without an entry of the decimal point. When the Add mode is activated, the decimal point is automatically positioned according to the decimal selector setting.

Use of [X], [X] and [÷] will automatically override the Add mode and decimally correct answers will be printed at the preset decimal position.

## ↑ 5/4 ↓

ROUNDING SELECTOR:

- "↑": An answer is rounded up.
- "5/4": An answer is rounded off.
- "↓": An answer is rounded down.

Note: The decimal point floats during successive calculation by the use of [X] or [÷].

If the decimal selector is set to "F" then the answer is always rounded down (↓).

## RATE

GT • SET  
GRAND TOTAL/RATE SETTING MODE SELECTOR:

"GT": Grand Total  
"•": Neutral  
"RATE SET": To set up date, time, conversion rate, and tax/discount rate, place the switch at the "RATE SET" position.

- Date:**
- Enter in the order of month, day and year, then press [M] to complete the entry.
  - Use [.] to separate month, day, and year.
  - When [M] is pressed, the number entered is evaluated and displayed as "date" if the value is within the following range: "Error" is displayed otherwise, and the previously set date is restored.  
Month: 1 - 12; day: 1 - 31; Year: 2000 - 2099 (in 4 digits) or 00 - 99 (in 2 digits)
- Time:**
- Enter in the order of hour, minutes, then press [M] to complete the entry.  
(There is no entry available for the seconds value. The clock starts at zero second.)
  - If the hour/minute digit is less than 10, it is not necessary to enter the first digit "0".
  - Use [.] to separate hour and minute values.
  - When [M] is pressed, the number entered is evaluated and displayed as "time" if the value is within the following range: "Error" is displayed otherwise, and the previously set time is restored.  
Hour: 0 - 23 (24-hour system for the hour entry),  
Minute: 0 - 59

- Conversion rate:**
- Press [K] twice, enter the conversion rate, followed by [M].
  - A maximum of 6 digits can be stored (decimal point is not counted as a digit).
- Tax / discount rate:**
- Press [K] twice, enter the tax rate, followed by [TAX].
  - Press [K] twice, enter the discount rate, followed by [Z] then [TAX].
  - A maximum of 4 digits can be stored (decimal point is not counted as a digit).

Note: • Be sure to set this selector to the "•" position after storing an each rate.  
• For the conversion rate and the tax / discount rate, a single value can be stored for each. If you enter a new rate, the previous rate will be cleared.

## TIME CALCULATION KEY:

- Utilize this key to enter hours and minutes in time calculations.
- Press this key after entering an hour or minute value. (There is no need to press this key when entering a second value.)
- To bypass hour entry, press this key after entering 0.
- To bypass minute entry, you may press this key alone, or press it after entering 0.
- When this key is pressed, if the preceding entry is in any of the following ranges, it is set as an hour or minute value:  
Hour: Within 6 digits  
Minute: 0 to 99 (An entry above 60 is rounded up to one hour. If a value of more than 3 digits is entered, only the least significant two digits take effect.)
- A second value is set when it is entered in the following range:  
Second: 0 to 99 (An entry above 60 is rounded up to one minute. If a value of more than 3 digits is entered, only the least significant two digits take effect.)

## CLOCK / CALENDAR KEY:

- Each time this key is pressed, the mode switches. Calculation mode → Date display mode → Clock display mode → Calculation mode
- Use this key also to adjust date and time (see "GRAND TOTAL / RATE SETTING MODE SELECTOR").

## PAPER FEED KEY

LAST DIGIT CORRECTION KEY  
GRAND TOTAL KEY  
CLEAR ENTRY KEY

**TOTAL KEY:**  
Press this key twice, followed by [TAX], to print the set tax rate.  
The tax rate is printed with the symbol "TX".

**MULTIPLICATION KEY**  
**DIVISION KEY**  
**MINUS EQUAL KEY**  
**PLUS EQUAL KEY**

**CHANGE SIGN KEY**  
**MARKUP KEY**  
**MEMORY TOTAL CLEAR KEY**  
**MEMORY SUBTOTAL RECALL KEY**

**MEMORY PLUS KEY**  
**MEMORY MINUS KEY**  
**TAX-INCLUDING KEY**  
**PRE-TAX KEY**  
**PERCENT KEY**

**NON-ADD/SUBTOTAL KEY:**  
**Non-add** – When this key is pressed right after an entry of a number in the Print mode, the entry is printed on the left-hand side with the symbol "F".  
This key is used to print out numbers not subjects to calculation such as code, date, etc.  
**Subtotal** – Used to get subtotal(s) of additions and/or subtractions. When pressed following the [±] or [M] key, the subtotal is printed with the symbol "ST" and the calculation may be continued.

**By pressing this key even in the Non-print mode, the displayed number is printed with the symbol "P".**  
When the POWER SWITCH; PRINT / ITEM COUNT MODE SELECTOR is set to "•", "P" or "P•C" position, and Dator Clock is displayed, press this key to print the displayed contents, including "F" symbol, from the left side of the paper roll.  
Example:  
Date printing  
#9 • 15 • 2004 • • • • •  
(when the date is September 15, 2004)  
Clock printing  
#10 • 30 A  
(when the time is 10:30 a.m.)  
#6 • 25  
(when the time is 6:25 p.m.)  
• When the Date / Clock printing is complete, the Calculation mode is restored.

**AVERAGE KEY:**  
Used to calculate the average.

**CONVERSION KEY:**  
This key is used:  
• to store the conversion rate (by the use of the rate setting mode selector),  
• obtains a value by multiplying a given number with a specified conversion rate.

• to recall the presently stored rate for check. Press [X] [.] first to clear the calculation register and reset an error condition, then press [M]. The conversion rate is printed with the symbol "TC".

**CONVERSION KEY:**  
This key is used to obtain a value by dividing a given number with a specified conversion rate.

## ↑ 5/4 ↓

SELECTOR DE REDONDEO:

- "↑": El resultado es redondeado hacia arriba.
- "5/4": El resultado no es redondeado.
- "↓": El resultado es redondeado hacia abajo.

Note: El punto decimal (= coma) decimal flota mientras se hacen cálculos sucesivos usando [X] o [÷].

Si el selector decimal se coloca en "F", la respuesta siempre se redondea por defecto (↓).

## RATE

GT • SET  
SELECTOR DEL MODO DE TOTAL GLOBAL/ FIJACIÓN DE TIPOS:

"GT": Total Global  
"•": Neutra  
"RATE SET": Para establecer la fecha, la hora, la tasa de conversión, y la tasa de impuestos/descuento, ponga el selector en la posición "RATE SET".

- Fecha:**
- Introduzca, por este orden, el mes, el día, y el año, y después pulse [M] para finalizar la introducción.
  - Utilice [.] para separar el mes, el día, y el año.
  - Cuando pulse [M], el número introducido se evaluará y visualizará como "fecha" si el valor introducido está dentro del margen; de lo contrario se visualizará "Error", y se restablecerá la fecha preestablecida.  
Mes: 1 - 12; día: 1 - 31; Year: 2000 - 2099 (introduzca 4 dígitos) o 00 - 99 (introduzca 2 dígitos)
- Hora:**
- Introduzca, por este orden, la hora y los minutos, y después pulse [M] para completar la introducción. (No es posible introducir los segundos. El reloj comenzará a funcionar a partir de cero segundos.)
  - Si los dígitos de la hora/minutos son inferiores a 10, no será necesario introducir el primer dígito "0".
  - Utilice [.] para separar los valores de la hora y los minutos.
  - Cuando pulse [M], el número introducido se evaluará y visualizará como "hora" si el valor está dentro de la gama; en caso contrario se visualizará "Error", y se restablecerá la hora previamente ajustada.  
Hora: 0 - 23 (sistema de 24 horas para la introducción de la hora), Minutos: 0 - 59

- Tasa de conversión:**
- Pulse [K] dos veces, introduzca la tasa de conversión, seguido por [M].
  - Se puede almacenar un máximo de 6 dígitos (la coma decimal no cuenta como un dígito).
- Tasa de impuesto / descuento:**
- Pulse [K] dos veces, introduzca la tasa de impuesto, seguido por [TAX].
  - Pulse [K] dos veces, introduzca la tasa de descuento, seguido por [Z] y después [TAX].
  - Se puede almacenar un máximo de 4 dígitos (la coma decimal no cuenta como un dígito).

Note: • Asegúrese de poner este selector en la posición "•" después de almacenar cada tipo.  
• Se puede almacenar un tipo de cada para la conversión y el impuesto / descuento. Si introduce un tipo nuevo, el tipo anterior se borrará.

## TECLA DE CÁLCULO DE TIEMPO:

- Utilice esta tecla para introducir horas y minutos en cálculos de tiempo.
- Pulse esta tecla tras introducir una valor de horas o minutos (no es necesario pulsar esta tecla cuando se introduce un valor de segundos).
- Para pasar por alto la entrada de horas, pulse esta tecla tras introducir 0.
- Para pasar por alto la entrada de minutos, podrá pulsar esta tecla sola o tras introducir 0.
- Cuando se pulse esta tecla, si la entrada precedente se encuentra dentro de cualquiera de los rangos siguientes, ésta se establecerá como un valor de horas o minutos:  
Hora: dentro de 6 dígitos  
Minuto: 0 a 99 (una entrada superior a 60 se redondeará a una hora. Si se introduce un valor de más de 3 dígitos, sólo tendrán efecto los dos dígitos menos significativos).
- Se establecerá un segundo valor cuando éste se introduzca dentro del rango siguiente:  
Segundo: 0 a 99 (una entrada superior a 60 se redondeará a un minuto. Si se introduce un valor de más de 3 dígitos, sólo tendrán efecto los dos dígitos menos significativos).

## TECLA DEL RELOJ / CALENDARIO:

- Cada vez que pulse esta tecla, el modo cambiará. Modo de cálculo → Modo de visualización de la fecha → Modo de visualización del reloj → Modo de cálculo
- Utilice esta tecla para ajustar también la fecha y la hora (consulte "SELECTOR DEL MODO DE TOTAL GLOBAL / FIJACIÓN DE TASA").

## TECLA DE AVANCE DEL PAPEL

TECLA DE CORRECCIÓN DE LA ÚLTIMA CIFRA  
TECLA DE TOTAL GLOBAL  
TECLA DE BORRADO DE ENTRADA

**TOTAL KEY:**  
Presione esta tecla dos veces, seguida por [TAX], para imprimir la tasa de impuestos establecida.  
El tasa de impuesto se imprime con el símbolo "TX".

**MULTIPLICACIÓN**  
**DIVISIÓN**  
**TECLA MENOS IGUAL**  
**TECLA MÁS IGUAL**

**TECLA DE CAMBIO DE SIGNO**  
**TECLA DE USO MÚLTIPLE**  
**TECLA DE TOTAL DE MEMORIA**  
**TECLA DE ACCESO A MEMORIA SUBTOTAL**

**TECLA DE SUMA EN MEMORIA**  
**TECLA DE RESTA EN MEMORIA**  
**TECLA DE INCLUSIÓN DE IMPUESTOS**  
**TECLA DE ANTES DE IMPUESTOS**  
**TECLA DE PORCENTAJE**

**TECLA DE NO SUMA/TOTAL PARCIAL:**  
**No-suma** – Cuando se aprieta esta tecla inmediatamente después de haber ingresado un número en el modo de impresión, el número registrado se imprime a la izquierda, junto con el símbolo "F".  
Esta tecla se usa para imprimir números que no están sujetos a cálculos como, por ejemplo, códigos, fechas, etc.  
Se usa para obtener uno o varios totales parciales de sumas y/o restas.  
Cuando se aprieta a continuación de la tecla [±] o [M], se imprimirá el total parcial junto con el símbolo "0" pudiéndose seguir con los cálculos.

**Total parcial** – Cuando se aprieta esta tecla inmediatamente después de haber ingresado un número en el modo de impresión, el número registrado se imprime a la izquierda, junto con el símbolo "F".  
Esta tecla se usa para imprimir números que no están sujetos a cálculos como, por ejemplo, códigos, fechas, etc.  
Se usa para obtener uno o varios totales parciales de sumas y/o restas.  
Cuando se aprieta a continuación de la tecla [±] o [M], se imprimirá el total parcial junto con el símbolo "0" pudiéndose seguir con los cálculos.

**Al apretar esta tecla, incluso en el modo de no impresión, se imprimirá el número que aparece en la exhibición con el símbolo "P".**  
Cuando el INTERRUPTOR DE ALIMENTACIÓN; SELECTOR DEL MODO DE IMPRESIÓN / MODO PARA CONTAR ARTÍCULOS esté en la posición "•" o "P•C", y se estuviera visualizando la fecha o la hora, pulse esta tecla para imprimir el contenido visualizado, incluyendo el símbolo "F", desde el lado derecho del rollo de papel.

Impresión de la fecha  
#9 • 15 • 2004 • • • • •  
(cuando la fecha sea el 15 de septiembre de 2004)  
Impresión del reloj  
#10 • 30 A  
(cuando la hora sea 10:30 a.m.)  
#6 • 25  
(cuando la hora sea 6:25 p.m.)  
• Cuando finalice la impresión de la fecha / hora, volverá al modo de cálculo.

**Al apretar esta tecla, incluso en el modo de no impresión, se imprimirá el número que aparece en la exhibición con el símbolo "P".**  
Cuando el INTERRUPTOR DE ALIMENTACIÓN; SELECTOR DEL MODO DE IMPRESIÓN / MODO PARA CONTAR ARTÍCULOS esté en la posición "•" o "P•C", y se estuviera visualizando la fecha o la hora, pulse esta tecla para imprimir el contenido visualizado, incluyendo el símbolo "F", desde el lado derecho del rollo de papel.

Impresión de la fecha  
#9 • 15 • 2004 • • • • •  
(cuando la fecha sea el 15 de septiembre de 2004)  
Impresión del reloj  
#10 • 30 A  
(cuando la hora sea 10:30 a.m.)  
#6 • 25  
(cuando la hora sea 6:25 p.m.)  
• Cuando finalice la impresión de la fecha / hora, volverá al modo de cálculo.

**Al apretar esta tecla, incluso en el modo de no impresión, se imprimirá el número que aparece en la exhibición con el símbolo "P".**  
Cuando el INTERRUPTOR DE ALIMENTACIÓN; SELECTOR DEL MODO DE IMPRESIÓN / MODO PARA CONTAR ARTÍCULOS esté en la posición "•" o "P•C", y se estuviera visualizando la fecha o la hora, pulse esta tecla para imprimir el contenido visualizado, incluyendo el símbolo "F", desde el lado derecho del rollo de papel.

Impresión de la fecha  
#9 • 15 • 2004 • • • • •  
(cuando la fecha sea el 15 de septiembre de 2004)  
Impresión del reloj  
#10 • 30 A  
(cuando la hora sea 10:30 a.m.)  
#6 • 25  
(cuando la hora sea 6:25 p.m.)  
• Cuando finalice la impresión de la fecha / hora, volverá al modo de cálculo.

**TECLA DE PROMEDIO:**  
Se usa para calcular el promedio.

**TECLA DE CONVERSIÓN:**  
Esta tecla se utiliza para:  
• Almacenar el tasa de conversión (utilizando el selector del modo de fijación de tipos).  
• Obtiene un valor multiplicando un número dado por una tasa de cambio especificada.

• Comprobar el tipo actualmente almacenado. Pulse primero [X] [.] para borrar el registro del cálculo y restablecer un condición de error, y luego pulse [M]. El tasa de conversión se imprime con el símbolo "TC".

**TECLA DE CONVERSIÓN:**  
Esta tecla se utiliza para obtener un valor dividiendo un número por un valor de conversión especificada.

## DISPLAY SYMBOLS:

- M : A number has been stored in memory.
- : The display value is negative.
- E : Error or overflow of capacity.
- : Appears when a number is in the grand total memory.

## INK RIBBON REPLACEMENT

- Remove the paper roll from the calculator. (Tear the paper and remove it from the print mechanism by using [R].)
- Turn the power off before replacing ribbon.
- Remove the printer cover. (Fig. 1)
- Remove the old ribbon by pulling it up.
- Insert the new ribbon.
- With the black side of the ribbon facing upwards, place one of the reels on the reel shaft on the right. (Fig. 2) Make sure that the reel is securely in place.
- Thread the ribbon around the outside of the metal guides. (Fig. 3)
- Take up any slack by manually turning one of the reels.
- Replace the printer cover. (Fig. 4)
- Replace the paper roll.

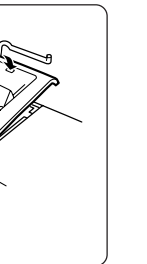
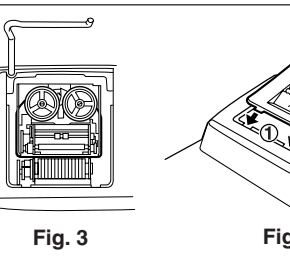
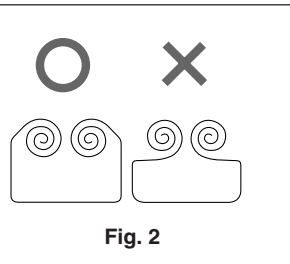
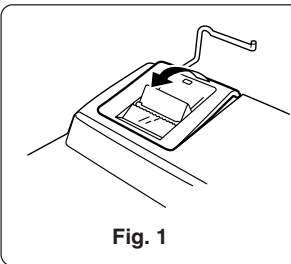

## PAPER ROLL REPLACEMENT

- Never insert paper roll if torn. Doing so will cause paper to jam.  
Always cut leading edge with scissors first.
- Insert the leading edge of the paper roll into the opening. (Fig. 1)
  - Turn the power on and feed the paper by pressing [R]. (Fig. 2)
  - Insert the paper roll to the paper holder. (Fig. 3)

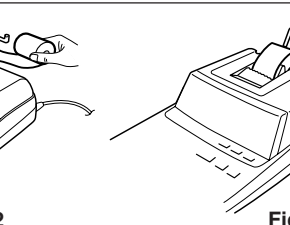
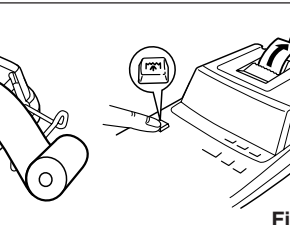
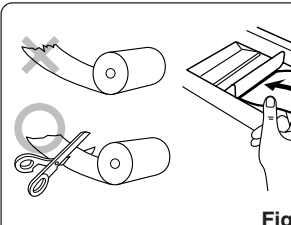

DO NOT PULL PAPER BACKWARDS AS THIS MAY CAUSE DAMAGE TO PRINTING MECHANISM.

NO TIRAR DEL PAPEL HACIA ATRÁS PUES PUEDE OCASIONAR DAÑOS AL MECANISMO DE IMPRESIÓN.

## ERRORS

There are several situations which will cause an overflow or an error condition. When this occurs, "E" will be displayed. The contents of the memory at the time of the error are retained.

If an "0-E" is displayed at the time of the error, [X] must be used to clear the calculator. If an "E" with any numerals except zero is displayed, the error may be cleared with [CE] or [C] and the calculation can still be continued.

Also, in rare cases, printing may stop midway and the indication "E" appear on the display. This is not a malfunction but is caused when the calculator is exposed to strong electromagnetic noise or static electricity from an external source. Should this occur, press the [X] key and then repeat the calculation from the beginning.

## Error conditions:

- Entry of more than 12 digits or 11 decimals. This error can be cleared with [CE] or [C].
- When the integer portion of an answer exceeds 12 digits.
- When the integer portion of the contents of the memory or grand total memory exceeds 12 digits.  
(Ex. [M] 999999999999 [M] 1 [M])
- When any number is divided by zero. (Ex. 5 [÷] 0 [E])

## REPLACEMENT OF BATTERY FOR MEMORY PROTECTION

**Time for battery replacement**  
Life of the memory protection battery is approximately 2,500 hours at 25°C(77°F) with the power plug not connected to the socket.

- When the memory protection battery is weak, the date/time setting is initialised (1/1/2005, 12:00:00 a.m.).
- Verify the date/time setting in the date/clock display mode when connecting the power plug to the socket.  
If the date/time setting is modified or incorrect, promptly replace the memory protection battery with new one.  
(The life of the pre-installed battery may be shorter than expected because of the time the calculator spends during shipment.)

## Method of battery replacement

Use one lithium battery (CR2032).  
**Caution:** Replacing the battery will clear the date and time settings, as well as the conversion rate, and the tax/discount rate.

- Turn the power switch "OFF" and unplug the power supply plug from the outlet.
- Remove the battery cover on the back of the unit. (Fig. 1)
- Remove the exhausted battery and install one new lithium battery. Wipe the battery well with a dry cloth and place the plus "+" side upward. (Fig. 2)
- Replace the battery cover by reversing the removal procedure.
- Press the RESET switch on the back of the unit. (See "RESETTING THE UNIT").

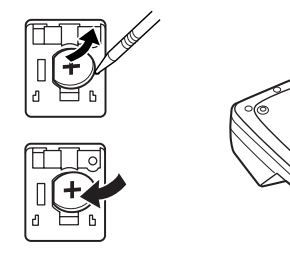
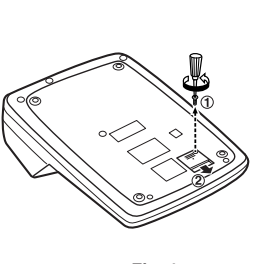

## After battery replacement

- Connect the power supply plug to an outlet and turn the power switch "ON".  
Check that "0." is displayed. If "0." is not displayed, remove the battery, reinstall it, and check the display again.
- Reconfigure date, time, conversion rate, and tax/discount rate.
- On the battery replacement date label found on the back of the unit, write down the month and year when the battery is replaced, as a reference for the next battery replacement.

## Precautions on battery use

- Do not leave an exhausted battery in the equipment.
- Do not expose the battery to water or flame, and do not take it apart.
- Store batteries out of the reach of small children.

## Notes for handling Lithium batteries:

**CAUTION**  
Danger of explosion if battery is incorrectly replaced.  
Replace only with the same or equivalent type recommended by the manufacturer.  
Dispose of used batteries according to the manufacturer's instructions.

## SIMBOLOS DEL VISUALIZADOR:

- M : Un número ha sido guardado en la memoria.
- : El valor del display es negativo.
- E : Error o desbordamiento de la capacidad.
- : Aparece cuando un número está en la memoria de total global.

## CAMBIO DE LA CINTA ENTINTADA

- Quitar el rollo de papel de la calculadora. (Cortar el papel y sacarlo del mecanismo impresor usando [R].)
- Desconecte el aparato antes de cambiar la cinta.
- Sacar la tapa de la impresora. (Fig. 1)
- Retire el rollo viejo empujando hacia arriba.
- Introduzca la cinta nueva.
- Con el lado negro de la cinta mirando para arriba, colocar uno de los carretes en el eje del carrete de la izquierda. (Fig. 2) Asegurarse de que el carrete esté firmemente colocado en su lugar.
- Passar la cinta por la parte exterior de las guías metálicas. (Fig. 3)
- Estirar cualquier parte de cinta floja girando con la mano uno de los carretes.
- Volver a poner la tapa de la impresora. (Fig. 4)
- Volver a poner el rollo de papel.





## Free Manuals Download Website

<http://myh66.com>

<http://usermanuals.us>

<http://www.somanuals.com>

<http://www.4manuals.cc>

<http://www.manual-lib.com>

<http://www.404manual.com>

<http://www.luxmanual.com>

<http://aubethermostatmanual.com>

Golf course search by state

<http://golfingnear.com>

Email search by domain

<http://emailbydomain.com>

Auto manuals search

<http://auto.somanuals.com>

TV manuals search

<http://tv.somanuals.com>