

Safety And Regulatory Information

Safety & Regulatory Information

The following sections contain notices for various countries:

Caution

This product is intended for use with FCC/CE certified computer equipment. Please check the equipment operating/installation manual and/or with the equipment manufacturer to verify/confirm if your equipment is suitable prior to the installation or use of the product.

Notice for USA

FCC Part 15: This equipment has been tested and found to comply with the limits for a Class B digital device, pursuant to Part 15 of the FCC Rules. These limits are designed to provide reasonable protection against harmful interference in a residential installation. This equipment generates, uses and can radiate radio frequency energy and, if not installed and used in accordance with the instructions, may cause harmful interference to radio communications. However, there is no guarantee that interference will not occur in a particular installation. If this equipment does cause harmful interference to radio or television reception, which can be determined by turning the equipment off and on, the user is encouraged to try to correct the interference by one or more of the following measures:

- Reorient or relocate the receiving antenna.
- Increase the separation between the equipment and receiver.
- Connect the equipment into an outlet on a circuit different from that to which the receiver is connected.
- Consult the dealer or an experienced radio/TV technician for help.

This device complies with part 15 of the FCC Rules. Operation is subject to the following two conditions:

1. This device may not cause harmful interference, and
2. This device must accept any interference received, including interference that may cause undesired operation.

Caution

To comply with the limits of the Class B digital device, pursuant to Part 15 of the FCC Rules, this device must be installed with computer equipment certified to comply with Class B limits. All cables used to connect to the computer and peripherals must be shielded and grounded. Operation with non-certified computers or non-shielded cables may result in interference to radio or television reception.

Modification

Any changes or modifications not expressly approved by the grantee of this device could void the user's authority to operate the device.

Notice for Canada

This Class B digital apparatus complies with Canadian ICES-003. Cet appareil numérique de la classe B est conforme à la norme NMB-003 du Canada.

Canadian Class B Statement

This digital device does not exceed the Class B limits for radio noise emissions from digital apparatus as set out in the interference-causing equipment standard entitled "Digital Apparatus," ICES-003 of the Department of Communications.

Cet appareil numérique respecte les limites de bruits radioélectriques applicables aux appareils numériques de Classe B prescrites dans la norme sur le matériel bruyant: "Appareils Numériques," NMB-003 édictée par le ministre des Communications.

MODIFICATION:

Any changes or modifications not expressly approved by the grantee of this device could void the user's authority to operate the device. Toute modification non approuvée explicitement par le fournisseur de licence de l'appareil peut entraîner l'annulation du droit de l'utilisateur à utiliser l'appareil.

State of California Proposition 65:

WARNING: Handling this product may expose you to chemicals known to the State of California to cause cancer and birth defects or other reproductive harm. *Wash hands after handling.*

Explanatory Note

California Safe Drinking Water and Toxic Enforcement Act of 1986 (Proposition 65) requires special product labeling for products containing certain chemicals known to the State of California to cause cancer, birth defects or other reproductive harm. Creative has chosen to provide a warning based on its knowledge about the presence of one or more listed chemicals without attempting to evaluate the level of exposure. With Creative's products, the exposure may be below the Proposition 65 level of concern, or could even be zero. However, out of an abundance of caution, Creative has elected to place the Proposition 65 warning on its products.

Safety Instructions

Safety instructions

Please read the following before using Creative products:

- To be completely disconnected from the power input, the mains plug has to be disconnected/detached from the mains
- Disconnect the mains plug when the device is expected to be unused for several days

Consignes de sécurité

Veillez lire les informations suivantes avant d'utiliser des produits Creative :

- Pour mettre l'appareil complètement hors tension, débranchez le câble d'alimentation de la prise secteur
- Débranchez le câble d'alimentation de la prise secteur si vous n'utilisez pas l'appareil pendant plusieurs jours

Instrucciones de seguridad

Lea las siguientes instrucciones antes de utilizar productos Creative:

- Para desconectarse completamente de la entrada de alimentación, debe desconectar el enchufe de alimentación de red de la corriente
- Desconecte el enchufe de alimentación de red cuando no vaya a utilizar el dispositivo durante varios días

Instruções de segurança

Leia as seguintes informações antes de utilizar produtos Creative:

- Certifique-se de que desliga a ficha de alimentação da corrente eléctrica
- Desligue a ficha de alimentação se o dispositivo não for utilizado durante um longo período de tempo

Güvenlik talimatları

Creative ürünü kullanmadan önce lütfen aşağıdaki talimatları okuyun:

- Elektrik girişinden tamamen bağlantıyı kesmek için, fişin prizden çıkarılması ya da bağlantısı kesilmiş olmalıdır
- Cihazı birkaç gün kullanmayacaksanız fişini prizden çekin

安全指示

在使用 Creative 產品之前, 請閱讀下文:

- 如要與電源輸入完全分開連接, 必須將主插頭從電源上分開/拔下
- 如果裝置在數日內不用, 請將主插頭分開連接

安全に関する注記

Creative製品をご使用になる前に以下をお読みください。

- 電源入力完全に切断するには、電源プラグをコンセントから抜きます。
- デバイスを数日間使用しない場合は、電源プラグをコンセントから抜きます。

安全使用说明

请先阅读以下内容, 然后再使用 Creative 产品:

- 要彻底切断电源输入, 需要拔下主插头或断开主插头与主线的连接
- 如果设备将闲置几天不用, 需切断其与主插头的连接

Instruksi keamanan

Mohon baca petunjuk dibawa ini sebelum menggunakan produk Creative:

- Untuk sepenuhnya lepas dari power input, colokan utama harus dilepaskan
- Mohon lepaskan colokan utama apabila berencana untuk tidak menggunakan speaker selama beberapa hari

EN English

Specifications

A320/SBS A320
Power output
Satellite speaker: **4 watts RMS per channel**
Subwoofer: **8 watts RMS**
Signal-to-Noise Ratio: **75dB**
Frequency Response: **40Hz - 20kHz**
Important Notice
The serial number for your A320/SBS A320 is located on the subwoofer. Please write this number down and keep it in a secure place.

ES Español

Especificaciones

A320/SBS A320
Salida de alimentación
Altavoz auxiliar: **4 vatios de carga eficaz por canal**
Altavoz de graves: **8 vatios de carga eficaz**
Relación de señal a ruido: **75dB**
Respuesta de frecuencias: **40Hz a 20kHz**
Aviso importante
El número de serie para A320/SBS A320 se encuentra en el altavoz de graves. Anote este número y guárdelo.

TR Türkçe

Özellikler

A320/SBS A320
Ses çıkışı
Satellite hoparlör: **Kanal başına 4 W RMS**
Subwoofer: **8 watt RMS**
İşaret-Gürültü Gücü Oranı: **75 dB**
Frekans Yanıtı: **40 Hz ~ 20 kHz**
Önemli
A320/SBS A320'ün seri numarası subwoofer üzerindedir. Lütfen bu numarayı bir yere not edin ve güvenli bir yerde saklayın.

JP 日本語

仕様

A320/SBS A320
出力
サテライトスピーカー: **4W RMS/チャンネル**
サブウーファー: **8W RMS**
SNR(S/N比): **75dB**
周波数特性: **40Hz ~ 20kHz**
注意事項
本製品のシリアルナンバーはサブウーファー上に記載されています。この番号を控えて保存しておいて下さい。

BI Bahasa Indonesia

Spesifikasi

A320/SBS A320
Pengeluaran energi
Penerima suara dengan satelit: **4 watt RMS per terusan**
Subwoofer: **8 watts RMS**
Menangkap sinyal radio sampai: **75dB**
Frekuensi: **40Hz - 20kHz**
Catatan penting
nomer seri untuk A320/SBS A320 terletak didalam satelit. Harap tulis nomer ini dibagian bawah dan simpan ditempat yang aman.

FR Français

Spécifications

A320/SBS A320
Sortie de l'alimentation
Haut-parleur satellite: **4 watts RMS par canal**
Caisson de basses: **8 watts RMS**
Rapport signal/bruit: **75dB**
Réponse en fréquence: **40Hz - 20kHz**
Avis important
Le numéro de série de votre A320/SBS A320 de Creative se trouve sur le caisson de basses. Veuillez prendre ce numéro en note et le conserver en lieu sûr.

BP Português do Brasil

Especificações

A320/SBS A320
Saída de alimentação
Alto-falante: **RMS de 4 watts por canal**
Subwoofer: **RMS de 8 watts**
Relação sinal/ruído: **75dB**
Resposta de frequência: **40Hz a 20kHz**
Nota importante
O número de série do seu A320/SBS A320 está localizado no subwoofer. Por favor, tome nota deste número e guarde-o em um lugar seguro.

CT 繁體中文

規格

A320/SBS A320
功率輸出
環繞喇叭: **每聲道 4 瓦 RMS**
低音喇叭: **8 瓦 RMS**
訊噪比: **75dB**
頻率響應: **40Hz ~ 20kHz**
重要提示
A320/SBS A320 的序號在低音喇叭上。請記下此序號並妥善保管。

CS 简体中文

规格

A320/SBS A320
功率输出
卫星音箱: **额定功率 4 瓦(每声道)**
低音炮: **额定功率 8 瓦**
信噪比: **75dB**
频率响应: **40Hz ~ 20kHz**
重要提示
A320/SBS A320 的序列号在低音炮上。请将此序列号记录下来并妥善保存。

CREATIVE



- EN Quick Start Guide
- FR Démarrage Rapide
- ES Guía Rápida
- BP Introdução rápida
- TR Kullanım
- CT 快速開始指南
- JP クイックスタートガイド
- CS 快速开始指南
- BI Permulaan baca buku panduan

© 2010, Creative Technology Ltd. All rights reserved. The Creative logo is either registered trademarks or trademarks of Creative Technology Ltd. in the United States and other countries. All other logos, brand or product names are trademarks or registered trademarks of their respective holders and are hereby recognised as such. All specifications are subject to change without notice. Use of this product is subject to a limited warranty. Actual contents may differ slightly from those pictured.

P/N 03MF04050000 Rev. A

A320 / SBS A320

• Connectivity Diagram • Schéma de connexion • Diagramm zur conectividad • Diagramm zur conectividade • Balant diyagram • 連接示意圖 • 接続図 • 连接示意图 • Sambungan jaringan berupa diagram

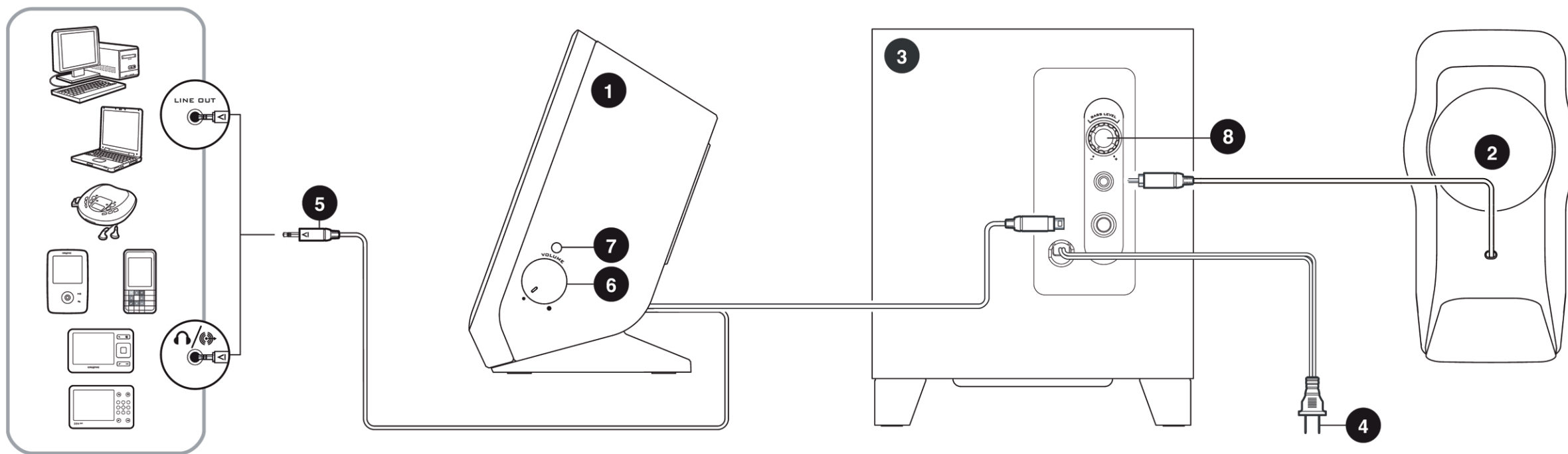

EN English	FR Français	ES Español	BP Português do Brasil	TR Türkçe	CT 繁體中文	JP 日本語	CS 简体中文	BI Bahasa Indonesia
1 Right Speaker	Haut-parleur droit	Altavoz derecho	Alto-falante direito	Sağ Hoparlör	右声道喇叭	サテライトスピーカー(右)	右卫星音箱	Pengeras Suara Kanan
2 Left Speaker	Haut-parleur gauche	Altavoz izquierdo	Alto-falante esquerdo	Sol Hoparlör	左声道喇叭	サテライトスピーカー(左)	左卫星音箱	Pengeras Suara Kiri
3 Subwoofer	Caisson de basses	Subgrave	Subwoofer	Subwoofer	低音喇叭	サブウーファー	低音炮	Subwoofer
4 To Wall Outlet	Vers la prise mural	A la toma de corriente	Para Tomada Eléctrica	Elektrik Fişi	至牆壁插座	ACコンセントへ接続	至牆壁插座	Ke stopkontak
5 To Analog Audio Source	Vers la source audio analogique	Fuente de sonido análoga	Fonte de áudio analógico	Analog Ses Kaynaklarına	至類比音源	オーディオ(アナログ)出力へ接続	接至模拟音源	Ke Sumber Audio Analog
6 Volume Control with Power ON/OFF Switch	Contrôle Du Volume Avec Interrupteur ON/OFF	Control De Volumen Con Interruptor De Encendido	Controle De Volume Com Chave De Liga/Desliga	Güç Açık/Kapalı Düğmesiyle Ses Yüksekliği Denetimi	带有电源开关的音量控制	ボリュームコントロール用ON/OFFスイッチ	带有电源开关的音量控制	pengatur volume dengan pemutar ON/OFF
7 Power LED	Diode électroluminescente POWER	LED Power	Indicador LED de alimentación	Güç LED'i	電源指示灯	パワーLED	电源 LED 指示灯	LED Daya
8 Bass Level Control	Bouton de réglage des basses	Control de nivel de graves	Control de nivel de graves	Güç LED'i	低音旋鈕	バスレベルコントロール	低音音量控制	Tingkat kontrol bass

Free Manuals Download Website

<http://myh66.com>

<http://usermanuals.us>

<http://www.somanuals.com>

<http://www.4manuals.cc>

<http://www.manual-lib.com>

<http://www.404manual.com>

<http://www.luxmanual.com>

<http://aubethermostatmanual.com>

Golf course search by state

<http://golfingnear.com>

Email search by domain

<http://emailbydomain.com>

Auto manuals search

<http://auto.somanuals.com>

TV manuals search

<http://tv.somanuals.com>