

21483  
**1½ H.P. Dust Collector**  
(Model 50-760)

INSTRUCTION MANUAL



PART NO. A03569 - 05-12-05  
Copyright © 2005 Delta Machinery

 **DELTA<sup>®</sup> INDUSTRIAL**

To learn more about DELTA MACHINERY  
visit our website at: [www.deltamachinery.com](http://www.deltamachinery.com).

For Parts, Service, Warranty or other Assistance,

please call **1-800-223-7278** (In Canada call **1-800-463-3582**).

RTD10000118AA

# TABLE OF CONTENTS

IMPORTANT SAFETY INSTRUCTIONS .....	2
SAFETY GUIDELINES .....	3
GENERAL SAFETY RULES .....	4
FUNCTIONAL DESCRIPTION .....	7
CARTON CONTENTS .....	7
ASSEMBLY .....	8
OPERATION .....	13
TROUBLESHOOTING .....	13
MAINTENANCE .....	14
SERVICE .....	14
ACCESSORIES .....	14
WARRANTY .....	14
SERVICE CENTER LOCATIONS .....	.back cover

## IMPORTANT SAFETY INSTRUCTIONS

**▲ WARNING** Read and understand all warnings and operating instructions before using any tool or equipment. When using tools or equipment, basic safety precautions should always be followed to reduce the risk of personal injury. Improper operation, maintenance or modification of tools or equipment could result in serious injury and property damage. There are certain applications for which tools and equipment are designed. Delta Machinery strongly recommends that this product NOT be modified and/or used for any application other than for which it was designed.

If you have any questions relative to its application DO NOT use the product until you have written Delta Machinery and we have advised you.

Online contact form at [www.deltamachinery.com](http://www.deltamachinery.com)

Postal Mail: Technical Service Manager  
Delta Machinery  
4825 Highway 45 North  
Jackson, TN 38305  
(IN CANADA: 125 Mural St. Suite 300, Richmond Hill, ON, L4B 1M4)

Information regarding the safe and proper operation of this tool is available from the following sources:

Power Tool Institute  
1300 Sumner Avenue, Cleveland, OH 44115-2851  
[www.powertoolinstitute.org](http://www.powertoolinstitute.org)

National Safety Council  
1121 Spring Lake Drive, Itasca, IL 60143-3201

American National Standards Institute, 25 West 43rd Street, 4 floor, New York, NY 10036 [www.ansi.org](http://www.ansi.org)  
ANSI 01.1 Safety Requirements for Woodworking Machines, and

the U.S. Department of Labor regulations [www.osha.gov](http://www.osha.gov)

**SAVE THESE INSTRUCTIONS!**

# SAFETY GUIDELINES - DEFINITIONS

It is important for you to read and understand this manual. The information it contains relates to protecting YOUR SAFETY and PREVENTING PROBLEMS. The symbols below are used to help you recognize this information.



- ▲ DANGER** Indicates an imminently hazardous situation which, if not avoided, will result in death or serious injury.
- ▲ WARNING** Indicates a potentially hazardous situation which, if not avoided, could result in death or serious injury.
- ▲ CAUTION** Indicates a potentially hazardous situation which, if not avoided, may result in minor or moderate injury.
- CAUTION** Used without the safety alert symbol indicates potentially hazardous situation which, if not avoided, may result in property damage.

---

## CALIFORNIA PROPOSITION 65

**▲ WARNING** **SOME DUST CREATED BY POWER SANDING, SAWING, GRINDING, DRILLING, AND OTHER CONSTRUCTION ACTIVITIES** contains chemicals known to cause cancer, birth defects or other reproductive harm.

Some examples of these chemicals are:

- lead from lead-based paints,
- crystalline silica from bricks and cement and other masonry products, and
- arsenic and chromium from chemically-treated lumber.

Your risk from these exposures varies, depending on how often you do this type of work. To reduce your exposure to these chemicals: work in a well ventilated area, and work with approved safety equipment, always wear **NIOSH/OSHA** approved, properly fitting face mask or respirator when using such tools.

# GENERAL SAFETY RULES



**⚠ WARNING** READ AND UNDERSTAND ALL WARNINGS AND OPERATING INSTRUCTIONS BEFORE USING THIS EQUIPMENT. Failure to follow all instructions listed below, may result in electric shock, fire, and/or serious personal injury or property damage.

## IMPORTANT SAFETY INSTRUCTIONS

- 1. FOR YOUR OWN SAFETY, READ THE INSTRUCTION MANUAL BEFORE OPERATING THE MACHINE.** Learning the machine's application, limitations, and specific hazards will greatly minimize the possibility of accidents and injury.
- 2. WEAR EYE AND HEARING PROTECTION. ALWAYS USE SAFETY GLASSES.** Everyday eyeglasses are NOT safety glasses. USE CERTIFIED SAFETY EQUIPMENT. Eye protection equipment should comply with ANSI Z87.1 standards. Hearing equipment should comply with ANSI S3.19 standards.
- 3. WEAR PROPER APPAREL.** Do not wear loose clothing, gloves, neckties, rings, bracelets, or other jewelry which may get caught in moving parts. Nonslip footwear is recommended. Wear protective hair covering to contain long hair.
- 4. DO NOT USE THE MACHINE IN A DANGEROUS ENVIRONMENT.** The use of power tools in damp or wet locations or in rain can cause shock or electrocution. Keep your work area well-lit to prevent tripping or placing arms, hands, and fingers in danger.
- 5. MAINTAIN ALL TOOLS AND MACHINES IN PEAK CONDITION.** Keep tools sharp and clean for best and safest performance. Follow instructions for lubricating and changing accessories. Poorly maintained tools and machines can further damage the tool or machine and/or cause injury.
- 6. CHECK FOR DAMAGED PARTS.** Before using the machine, check for any damaged parts. Check for alignment of moving parts, binding of moving parts, breakage of parts, and any other conditions that may affect its operation. A guard or any other part that is damaged **should be properly repaired or replaced**. Damaged parts can cause further damage to the machine and/or injury.
- 7. KEEP THE WORK AREA CLEAN.** Cluttered areas and benches invite accidents.
- 8. KEEP CHILDREN AND VISITORS AWAY.** Your shop is a potentially dangerous environment. Children and visitors can be injured.
- 9. REDUCE THE RISK OF UNINTENTIONAL STARTING.** Make sure that the switch is in the "OFF" position before plugging in the power cord. In the event of a power failure, move the switch to the "OFF" position. An accidental start-up can cause injury.
- 10. USE THE GUARDS.** Check to see that all guards are in place, secured, and working correctly to reduce the risk of injury.
- 11. REMOVE ADJUSTING KEYS AND WRENCHES BEFORE STARTING THE MACHINE.** Tools, scrap pieces, and other debris can be thrown at high speed, causing injury.
- 12. USE THE RIGHT MACHINE.** Don't force a machine or an attachment to do a job for which it was not designed. Damage to the machine and/or injury may result.
- 13. USE RECOMMENDED ACCESSORIES.** The use of accessories and attachments not recommended by Delta may cause damage to the machine or injury to the user.
- 14. USE THE PROPER EXTENSION CORD.** Make sure your extension cord is in good condition. When using an extension cord, be sure to use one heavy enough to carry the current your product will draw. An undersized cord will cause a drop in line voltage, resulting in loss of power and overheating. See the Extension Cord Chart for the correct size depending on the cord length and nameplate ampere rating. If in doubt, use the next heavier gauge. The smaller the gauge number, the heavier the cord.
- 15. SECURE THE WORKPIECE.** Use clamps or a vise to hold the workpiece when practical. Loss of control of a workpiece can cause injury.
- 16. FEED THE WORKPIECE AGAINST THE DIRECTION OF THE ROTATION OF THE BLADE, CUTTER, OR ABRASIVE SURFACE.** Feeding it from the other direction will cause the workpiece to be thrown out at high speed.
- 17. DON'T FORCE THE WORKPIECE ON THE MACHINE.** Damage to the machine and/or injury may result.
- 18. DON'T OVERREACH.** Loss of balance can make you fall into a working machine, causing injury.
- 19. NEVER STAND ON THE MACHINE.** Injury could occur if the tool tips, or if you accidentally contact the cutting tool.
- 20. NEVER LEAVE THE MACHINE RUNNING UNATTENDED. TURN THE POWER OFF.** Don't leave the machine until it comes to a complete stop. A child or visitor could be injured.
- 21. TURN THE MACHINE "OFF", AND DISCONNECT THE MACHINE FROM THE POWER SOURCE** before installing or removing accessories, before adjusting or changing set-ups, or when making repairs. An accidental start-up can cause injury.
- 22. MAKE YOUR WORKSHOP CHILDPROOF WITH PADLOCKS, MASTER SWITCHES, OR BY REMOVING STARTER KEYS.** The accidental start-up of a machine by a child or visitor could cause injury.
- 23. STAY ALERT, WATCH WHAT YOU ARE DOING, AND USE COMMON SENSE. DO NOT USE THE MACHINE WHEN YOU ARE TIRED OR UNDER THE INFLUENCE OF DRUGS, ALCOHOL, OR MEDICATION.** A moment of inattention while operating power tools may result in injury.
- 24. ⚠ WARNING USE OF THIS TOOL CAN GENERATE AND DISBURSE DUST OR OTHER AIRBORNE PARTICLES, INCLUDING WOOD DUST, CRYSTALLINE SILICA DUST AND ASBESTOS DUST.** Direct particles away from face and body. Always operate tool in well ventilated area and provide for proper dust removal. Use dust collection system wherever possible. Exposure to the dust may cause serious and permanent respiratory or other injury, including silicosis (a serious lung disease), cancer, and death. Avoid breathing the dust, and avoid prolonged contact with dust. Allowing dust to get into your mouth or eyes, or lay on your skin may promote absorption of harmful material. Always use properly fitting NIOSH/OSHA approved respiratory protection appropriate for the dust exposure, and wash exposed areas with soap and water.

## POWER CONNECTIONS

A separate electrical circuit should be used for your machines. This circuit should not be less than #12 wire and should be protected with a 20 Amp time lag fuse. If an extension cord is used, use only 3-wire extension cords which have 3-prong grounding type plugs and matching receptacle which will accept the machine's plug. Before connecting the machine to the power line, make sure the switch (s) is in the "OFF" position and be sure that the electric current is of the same characteristics as indicated on the machine. All line connections should make good contact. Running on low voltage will damage the machine.

**⚠ DANGER DO NOT EXPOSE THE MACHINE TO RAIN OR OPERATE THE MACHINE IN DAMP LOCATIONS.**

## MOTOR SPECIFICATIONS

Your machine is wired for 120 volts, 60 HZ alternating current. Before connecting the machine to the power source, make sure the switch is in the "OFF" position.

## GROUNDING INSTRUCTIONS

**⚠ DANGER THIS MACHINE MUST BE GROUNDED WHILE IN USE TO PROTECT THE OPERATOR FROM ELECTRIC SHOCK.**

### 1. All grounded, cord-connected machines:

In the event of a malfunction or breakdown, grounding provides a path of least resistance for electric current to reduce the risk of electric shock. This machine is equipped with an electric cord having an equipment-grounding conductor and a grounding plug. The plug must be plugged into a matching outlet that is properly installed and grounded in accordance with all local codes and ordinances.

Do not modify the plug provided - if it will not fit the outlet, have the proper outlet installed by a qualified electrician.

Improper connection of the equipment-grounding conductor can result in risk of electric shock. The conductor with insulation having an outer surface that is green with or without yellow stripes is the equipment-grounding conductor. If repair or replacement of the electric cord or plug is necessary, do not connect the equipment-grounding conductor to a live terminal.

Check with a qualified electrician or service personnel if the grounding instructions are not completely understood, or if in doubt as to whether the machine is properly grounded.

Use only 3-wire extension cords that have 3-prong grounding type plugs and matching 3-conductor receptacles that accept the machine's plug, as shown in Fig. A.

Repair or replace damaged or worn cord immediately.

### 2. Grounded, cord-connected machines intended for use on a supply circuit having a nominal rating less than 150 volts:

If the machine is intended for use on a circuit that has an outlet that looks like the one illustrated in Fig. A, the machine will have a grounding plug that looks like the plug illustrated in Fig. A. A temporary adapter, which looks like the adapter illustrated in Fig. B, may be used to connect this plug to a matching 2-conductor receptacle as shown in Fig. B if a properly grounded outlet is not available. The temporary adapter should be used only until a properly grounded outlet can be installed by a qualified electrician. The green-colored rigid ear, lug, and the like, extending from the adapter must be connected to a permanent ground such as a properly grounded outlet box. Whenever the adapter is used, it must be held in place with a metal screw.

**NOTE: In Canada, the use of a temporary adapter is not permitted by the Canadian Electric Code.**

**⚠ DANGER IN ALL CASES, MAKE CERTAIN THE RECEPTACLE IN QUESTION IS PROPERLY GROUNDED. IF YOU ARE NOT SURE HAVE A QUALIFIED ELECTRICIAN CHECK THE RECEPTACLE.**

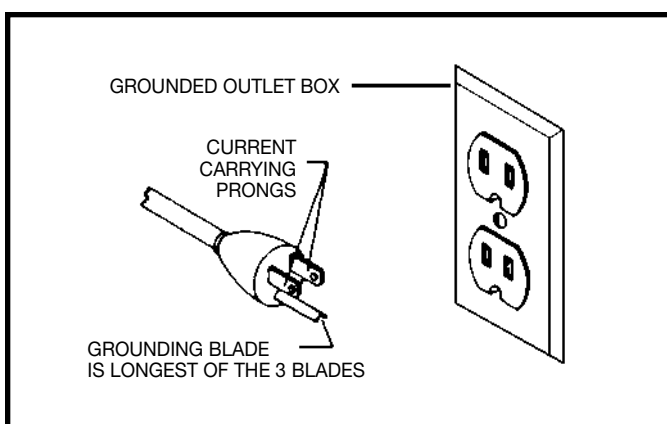

Fig. A

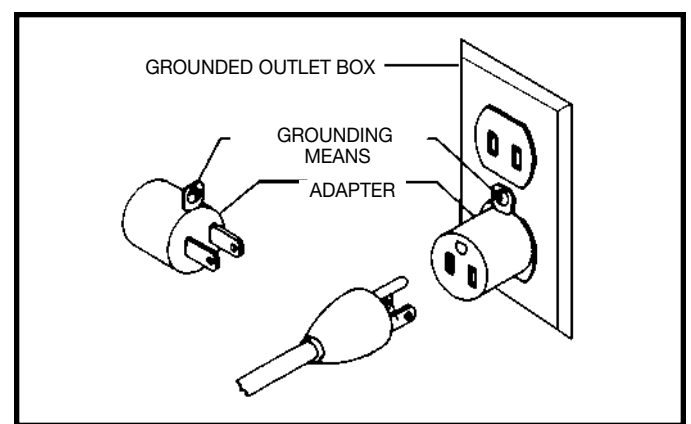

Fig. B

### 3. 240 VOLT SINGLE PHASE OPERATION

The motor supplied with your machine is a dual voltage, 120/240 volt motor. It is shipped ready-to-run for 120 volt operation. However, it can be converted for 240 volt operation. A qualified electrician should do the conversion, or the machine can be taken to an Authorized Delta Service Center. When completed, the machine must conform to the National Electric Code and all local codes and ordinances. The machine is converted by replacing the current plug and switch with UL/CSA listed parts which are suitable for 240 volts and the rated current of the machine. Be sure the 240 volt plug is only used in an outlet having the same configuration as the plug illustrated in Fig. C. No adapter should be used with the 240 volt plug.

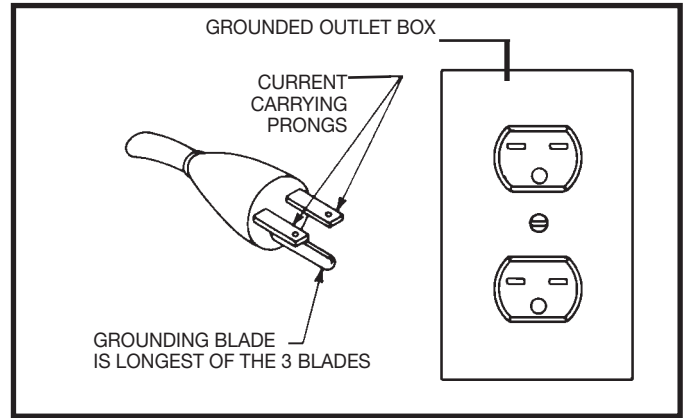

Fig. C

**⚠ WARNING** IN ALL CASES, MAKE CERTAIN THAT THE RECEPTACLE IN QUESTION IS PROPERLY GROUNDED. IF YOU ARE NOT SURE, HAVE A QUALIFIED ELECTRICIAN CHECK THE RECEPTACLE.

MINIMUM GAUGE EXTENSION CORD			
RECOMMENDED SIZES FOR USE WITH STATIONARY ELECTRIC MACHINES			
Ampere Rating	Volts	Total Length of Cord in Feet	Gauge of Extension Cord
0-6	120	up to 25	18 AWG
0-6	120	25-50	16 AWG
0-6	120	50-100	16 AWG
0-6	120	100-150	14 AWG
6-10	120	up to 25	18 AWG
6-10	120	25-50	16 AWG
6-10	120	50-100	14 AWG
6-10	120	100-150	12 AWG
10-12	120	up to 25	16 AWG
10-12	120	25-50	16 AWG
10-12	120	50-100	14 AWG
10-12	120	100-150	12 AWG
12-16	120	up to 25	14 AWG
12-16	120	25-50	12 AWG
12-16	120	GREATER THAN 50 FEET NOT RECOMMENDED	

Fig. D-1

### EXTENSION CORDS

**⚠ WARNING** Use proper extension cords. Make sure your extension cord is in good condition and is a 3-wire extension cord which has a 3-prong grounding type plug and matching receptacle which will accept the machine's plug. When using an extension cord, be sure to use one heavy enough to carry the current of the machine. An undersized cord will cause a drop in line voltage, resulting in loss of power and overheating. Fig. D-1 or D-2, shows the correct gauge to use depending on the cord length. If in doubt, use the next heavier gauge. The smaller the gauge number, the heavier the cord.

MINIMUM GAUGE EXTENSION CORD			
RECOMMENDED SIZES FOR USE WITH STATIONARY ELECTRIC MACHINES			
Ampere Rating	Volts	Total Length of Cord in Feet	Gauge of Extension Cord
0-6	240	up to 50	18 AWG
0-6	240	50-100	16 AWG
0-6	240	100-200	16 AWG
0-6	240	200-300	14 AWG
6-10	240	up to 50	18 AWG
6-10	240	50-100	16 AWG
6-10	240	100-200	14 AWG
6-10	240	200-300	12 AWG
10-12	240	up to 50	16 AWG
10-12	240	50-100	16 AWG
10-12	240	100-200	14 AWG
10-12	240	200-300	12 AWG
12-16	240	up to 50	14 AWG
12-16	240	50-100	12 AWG
12-16	240	GREATER THAN 100 FEET NOT RECOMMENDED	

Fig. D-2

# FUNCTIONAL DESCRIPTION

## FOREWORD

The Delta Industrial Model 50-760 Dust Collector will connect to woodworking machines that accept a 4" diameter hose. The 50-760 comes with one 1 micron filter bag and two 6 mil plastic collection bag, and a 4" x 5 ft. collection hose.

**NOTICE: THE PHOTO ON THE MANUAL COVER ILLUSTRATES THE CURRENT PRODUCTION MODEL. ALL OTHER ILLUSTRATIONS CONTAINED IN THE MANUAL ARE REPRESENTATIVE ONLY AND MAY NOT DEPICT THE ACTUAL COLOR, LABELING OR ACCESSORIES AND ARE INTENDED TO ILLUSTRATE TECHNIQUE ONLY.**

## CARTON CONTENTS

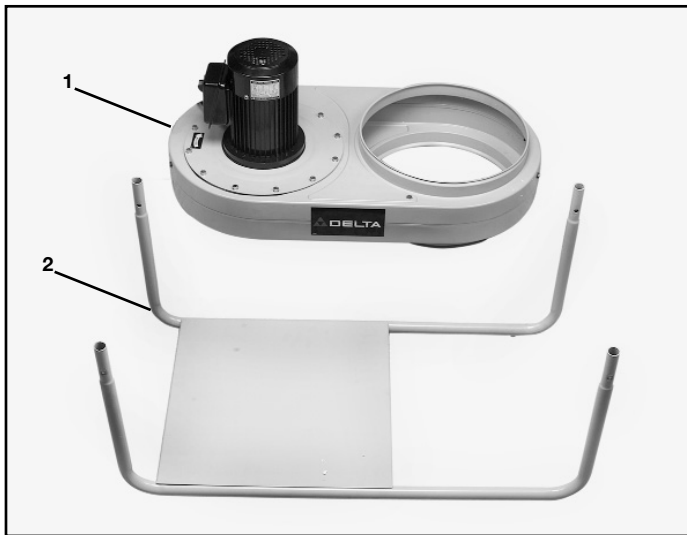

Fig. 1

1. Motor and blower assembly
2. Stand

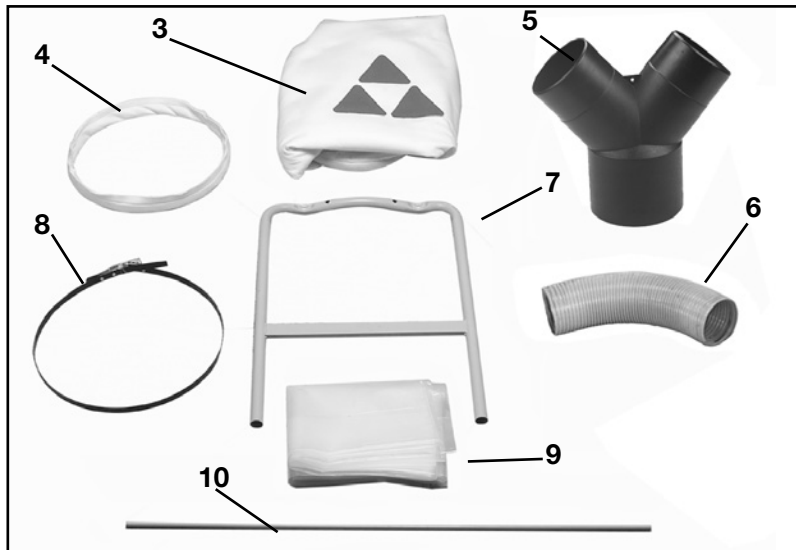

Fig. 1A

3. One micron upper filter bag
4. Cloth-covered bag retainer ring
5. Dust intake ports
6. 4" Hose
7. Legs (2)
8. Bag retainer clamp
9. Six mil plastic lower bag (2)
10. Bag hanging rod

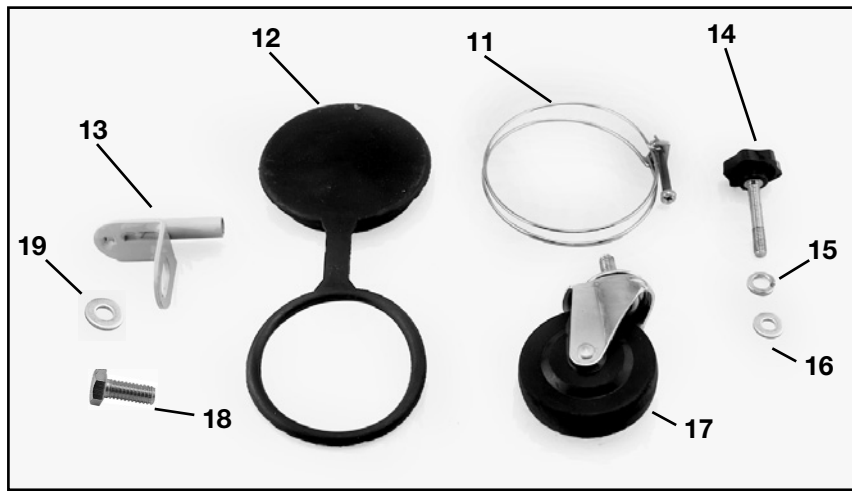

Fig. 1B

- |  |  |
|--|--|
| 11. Hose clamp (2)   | 16. 5/16" Small flat washers for attaching legs to blower/motor assembly (4) |
| 12. Intake cap and ring (2)                                    | 17. Caster (4)   |
| 13. Bracket for bag hanging rod                                | 18. 5/16" (8mm) Hex head screw for attaching bracket for bag hanging rod     |
| 14. Knob for attaching legs to blower/motor assembly (4)       | 19. 5/16" Large flat washer for bracket (1)                                  |
| 15. 3/8" (9.5mm) Lockwasher for attaching casters to stand (4) |  |

## UNPACKING AND CLEANING

Carefully unpack the machine and all loose items from the shipping container(s).

# ASSEMBLY

## ASSEMBLY TOOLS REQUIRED

\* Phillips head screwdriver

\* 12 mm wrench

**ASSEMBLY TIME ESTIMATE - 30 minutes to 1 hour**



**⚠ WARNING** FOR YOUR OWN SAFETY, DO NOT CONNECT THE MACHINE TO THE POWER SOURCE UNTIL THE MACHINE IS COMPLETELY ASSEMBLED AND YOU READ AND UNDERSTAND THE ENTIRE INSTRUCTION MANUAL.

**⚠ CAUTION** THIS MACHINE IS HEAVY. USE TWO OR MORE PEOPLE WHEN LIFTING.

## CASTERS

1. Turn stand (A) upside down, as shown in Fig 1C.
2. Place 3/8" lockwasher on caster stud (B) and screw caster into threaded hole on the bottom of the stand. Repeat for other three casters.
3. Tighten caster by hand, then set with a thin 14mm wrench.

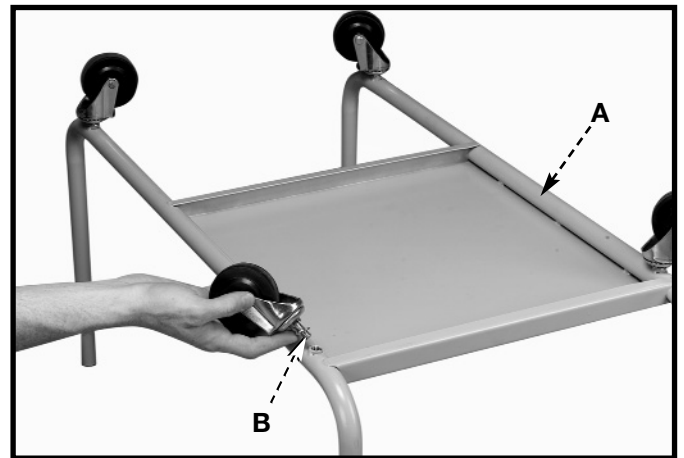

Fig. 1C

## LEGS TO MOTOR/BLOWER ASSEMBLY

1. Place motor/blower assembly with the motor (A) Fig. 2 down.
2. Place small 5/16" flatwasher on knob (B).
3. Align holes on legs (C) with holes (D) in the motor/blower assembly. Legs should extend up. Insert knob through hole in the legs (C) and into threaded hole in the motor/blower assembly (D). Tighten knob securely.
4. Repeat steps for all knobs on both legs.

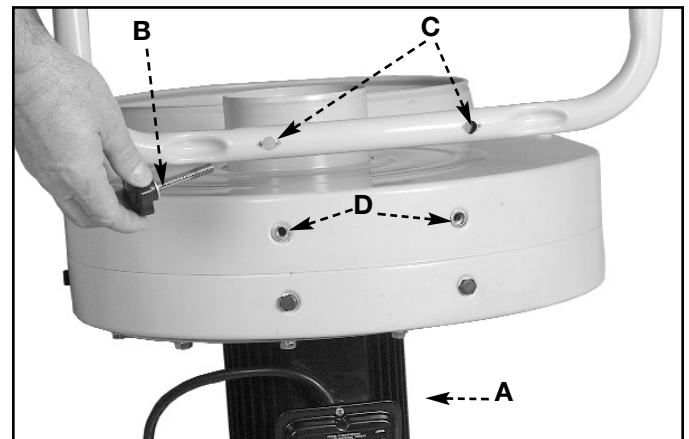

Fig. 2

## ATTACHING STAND TO MOTOR/BLOWER ASSEMBLY

**NOTE: TWO PEOPLE ARE NEEDED FOR THIS STEP.**

Place all four stand posts (A) Fig. 3 (three shown) into four legs (B) on motor/blower assembly. Make sure metal base plate (D) is arranged over the large dust collection hole (C).

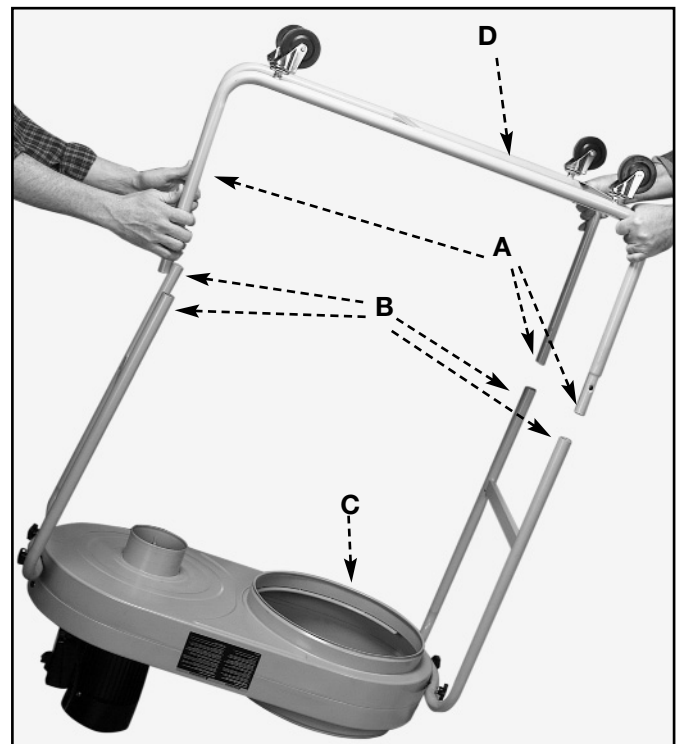

Fig. 3

## ALTERNATE SETUP

The steps so far will assemble the unit with the motor on top and dust intake ports on bottom, as shown in Fig 4.

This unit can be assembled with the intake port (B) Fig. 5 in the up position by following the steps in “**LEGS TO MOTOR/BLOWER ASSEMBLY.**” The exception is to place the motor/blower assembly on a flat surface with the motor (A) Fig. 6 facing up before attaching legs.

**NOTE: BEFORE DOING THE ALTERNATE SETUP, REMOVE 5/16” HEX HEAD SCREWS FROM HOLES (B) (FIG. 6) IN MOTOR/BLOWER ASSEMBLY AND PLACE IN HOLES (C). AIR LEAKAGE WOULD OCCUR IF SCREWS ARE NOT PLACED IN HOLES (C).**

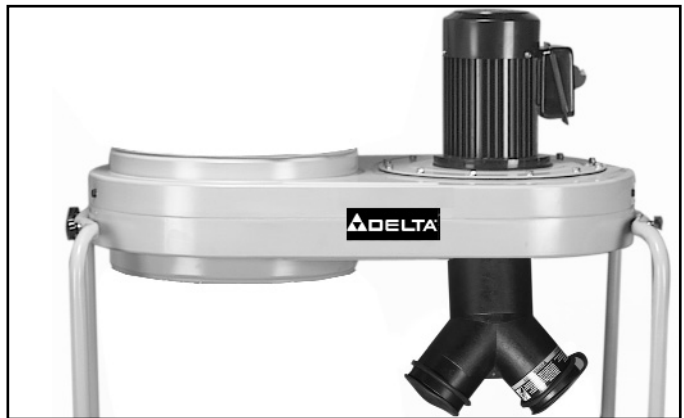

Fig. 4

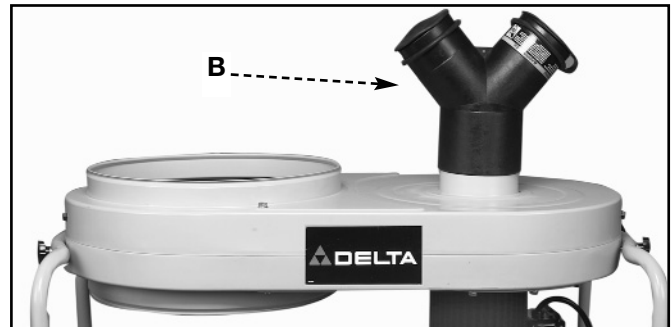

Fig. 5

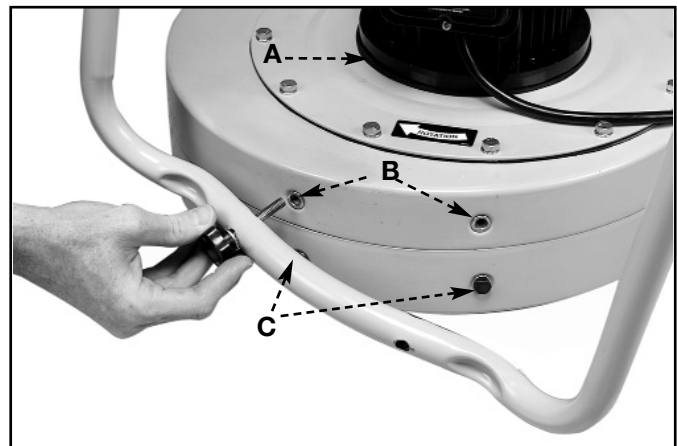

Fig. 6

## ATTACHING DUST INTAKE PORTS

**⚠ WARNING** DISCONNECT MACHINE FROM POWER SOURCE

Place dust intake port (A) Fig. 7 onto and around intake flange (B) opposite the motor. Dust intake port should be snug on the intake flange.

Turn unit over so casters are on the ground.

**⚠ CAUTION** BECAUSE OF THE WEIGHT OF THE UNIT, MORE THAN ONE PERSON SHOULD LIFT MOTOR/BLOWER ASSEMBLY INTO UPRIGHT POSITION.

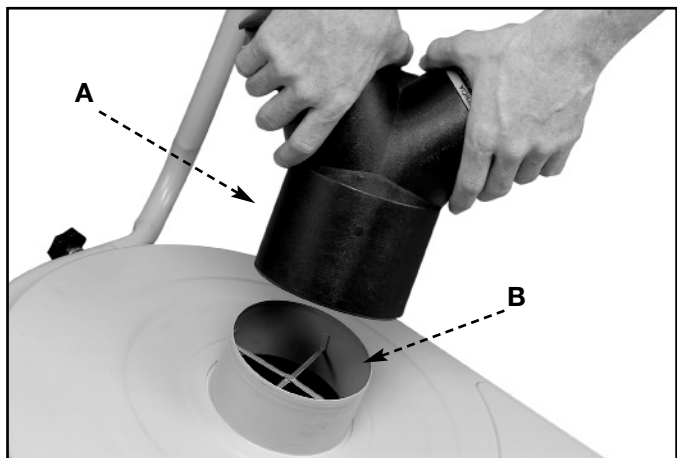

Fig. 7

## ATTACHING DUST COLLECTION BAG

**⚠ WARNING** DISCONNECT MACHINE FROM POWER SOURCE

### USING CLOTH COVERED FLEXIBLE RING:

1. Take cloth-covered bag retainer ring (A) Fig. 8 and place it inside opening of clear plastic dust collection bag. Fold about 6 inches of the bag down around the retainer ring.
2. Place bag in large hole (B) Fig. 8 in motor/blower assembly and fit retainer ring (A) Fig. 8 and (A) Fig. 9 into bottom groove (B) Fig. 9. It will be necessary to bend and fold the ring to fit it into place.
3. Tug slightly on bag to eliminate any slack and to make sure there is a good fit so the bag will not detach during collection.

### USING METAL BAG CLAMP:

The plastic bag can also be attached to the outside of the dust collector using the included clamp (B) Fig. 10:

1. Place clamp (B) around top of plastic bag (A) and fold about 4 to 6 inches of plastic bag over the clamp as show in Fig. 10.
2. Place the clamp and plastic bag assembly (A) Fig. 10A and fasten clamp securely as shown.

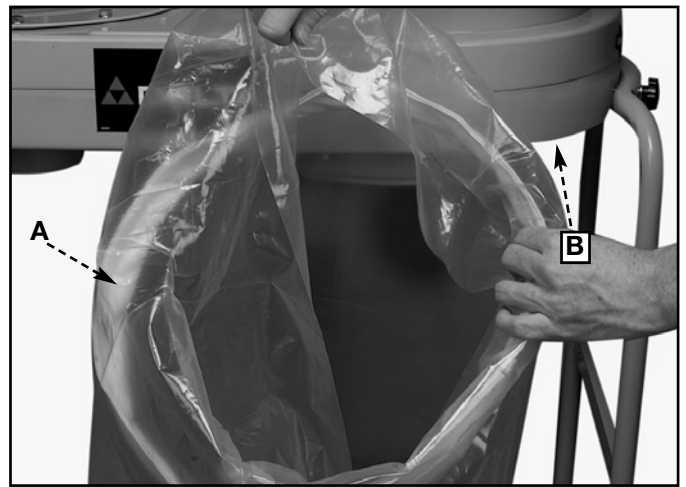

Fig. 8

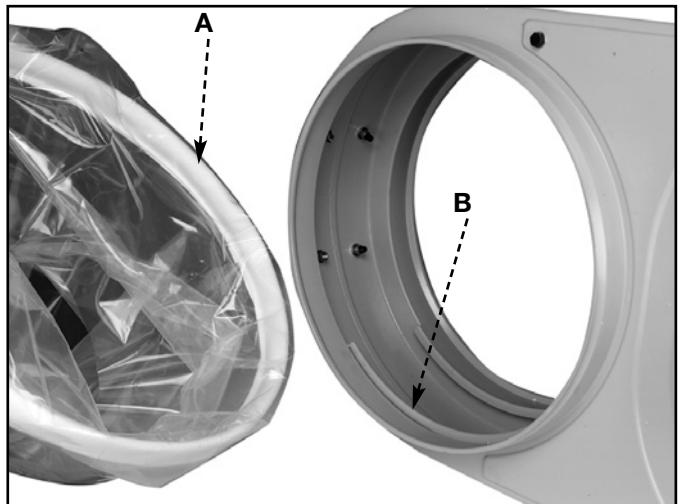

Fig. 9

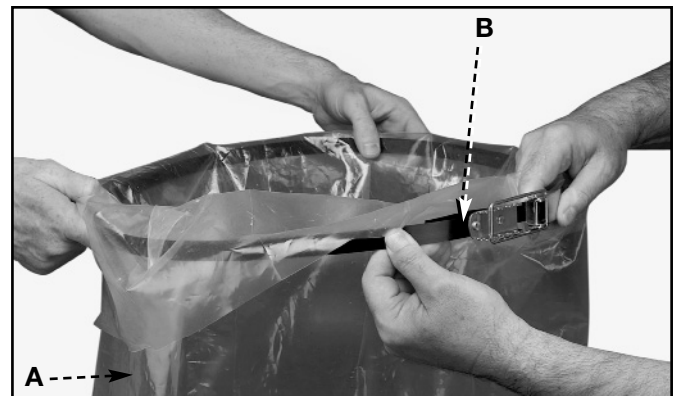

Fig. 10

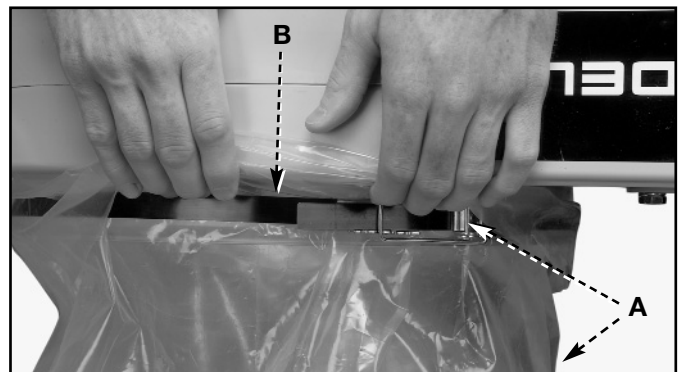

Fig. 10A

## ATTACHING TOP FILTER BAG

**⚠ WARNING** DISCONNECT MACHINE FROM POWER SOURCE

1. Assemble large 5/16" flatwasher onto 5/16" hex head screw.
2. Position bracket (A) to dust collector as shown in Fig. 11.
3. Insert 5/16" hex head screw through hole in bracket and thread into the hole in dust collector. Tighten securely with a 12 mm wrench.
4. Insert rod (A) Fig. 12 into pocket on filter bag.
5. Insert rod (A) into hole in bracket (B).
6. Work open end of filter bag into top groove of dust collector drum until secure and sealed. It will be necessary to bend and fold the internal bag retainer ring to fit it into place.

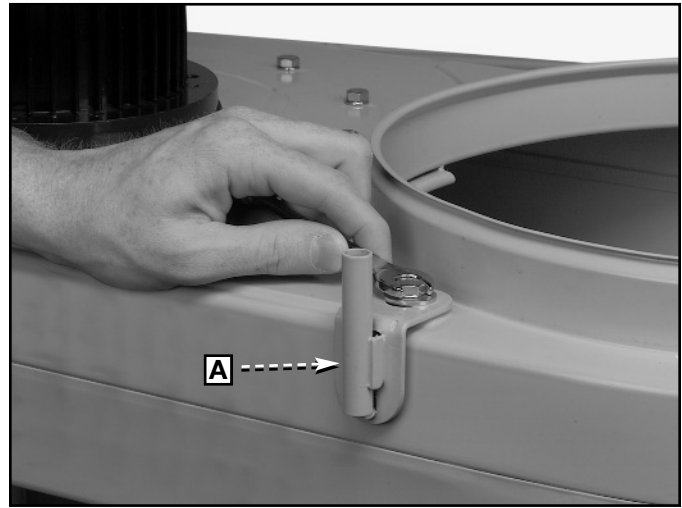

Fig. 11

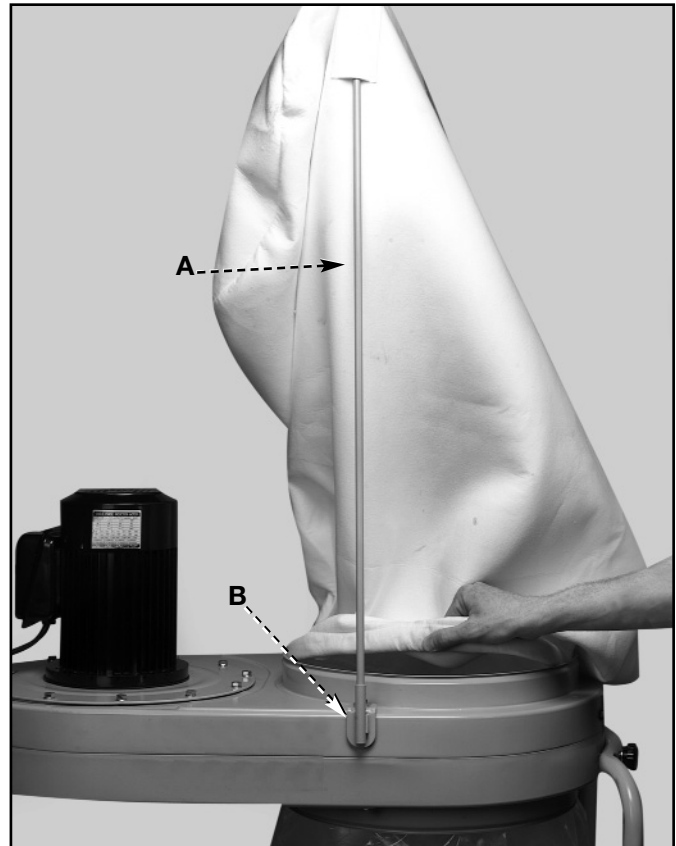

Fig. 12

## ATTACHING HOSE TO INTAKE PORT

**⚠ WARNING** DISCONNECT MACHINE FROM POWER SOURCE BEFORE CONNECTING OR DISCONNECTING HOSE .

Model 50-760 provides two 4" dust ports. Proceed as follows for each port with your hose.

**NOTE:** Place open end (D) of intake cap rings around and onto ends of each dust intake port before attaching the hose.

To assemble the 4" dust collection hose to the motor and blower assembly, loosely attach hose clamp (A) Fig. 13, around one end of flexible hose (B) and assemble the hose to dust intake port (C). Tighten hose clamp (A). Assemble the remaining clamp to the other end of the flexible hose and to the woodworking machine.

**NOTE:** Do not operate the dust collector with either of the holes in dust intake port (C) Fig. 13 uncovered. To cover a hole not being used by a hose, place the flat intake cap (E) on dust intake port as shown in Fig. 13.

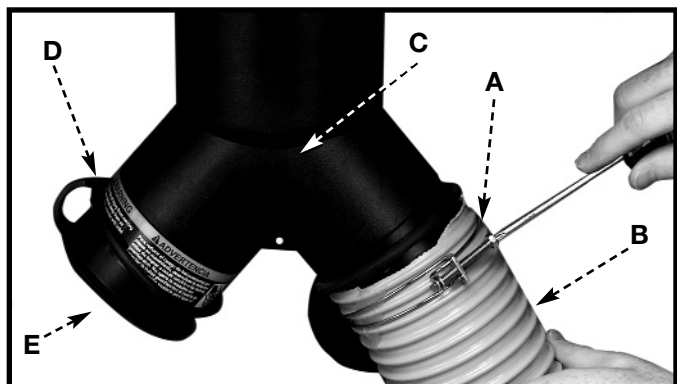

Fig. 13



# OPERATION

**⚠ WARNING** FOR OPERATOR SAFETY, DO NOT OPERATE THE MACHINE WITH ANY DUST INTAKE HOLES UNCOVERED. THE ROTATING FAN LOCATED INSIDE THE BLOWER HOUSING IS ACCESSIBLE THROUGH THE DUST IN-TAKE PORT AND CAN BE HAZARDOUS. ALWAYS WEAR PROPER APPAREL. DO NOT WEAR JEWELRY AND KEEP FINGERS AND ALL FOREIGN OBJECTS OUT OF THE DUST INTAKE PORT. FOLLOW THE SAFETY RULES IN THIS MANUAL.

## STARTING AND STOPPING DUST COLLECTOR

1. The on/off switch (A) Fig. 14 is located on the motor housing. To turn the machine “ON”, move the switch up to the “ON” position.
2. To turn the machine “OFF”, move the switch (A) down to the “OFF” position.

**⚠ WARNING** MAKE SURE THAT THE SWITCH IS IN THE “OFF” POSITION BEFORE PLUGGING IN THE POWER CORD. IN THE EVENT OF A POWER FAILURE, MOVE THE SWITCH TO THE “OFF” POSITION. AN ACCIDENTAL START-UP CAN CAUSE INJURY.

## LOCKING SWITCH IN “OFF” POSITION

**IMPORTANT:** When the tool is not in use, the switch should be locked in the “OFF” position to prevent unauthorized use. To lock the machine, grasp the switch toggle (A) Fig. 15 and pull it out of the switch (B). With the switch toggle (A) removed, the switch will not operate. However, should the switch toggle be removed while the saw is running, the machine can be turned “OFF,” but cannot be restarted without re-inserting the switch toggle (A).



Fig. 14



Fig. 15

**⚠ WARNING** WHEN USING THIS DUST COLLECTOR, DO NOT PICK UP ANYTHING THAT IS BURNING, SMOLDERING OR SMOKING, SUCH AS MATCHES, CIGARETTES, OR HOT ASHES.

**⚠ WARNING** DO NOT USE TO VACUUM COMBUSTIBLE EXPLOSIVE MATERIALS, SUCH AS COAL, GRAIN OR OTHER FINELY DIVIDED COMBUSTIBLE MATERIAL.

**⚠ WARNING** DO NOT USE TO VACUUM HAZARDOUS, TOXIC, OR CARCINOGENIC MATERIALS SUCH AS ASBESTOS, PESTICIDE OR LEAD-BASED PAINT DEBRIS.

## TROUBLESHOOTING GUIDE

For assistance with your tool, visit our website at [www.deltamachinery.com](http://www.deltamachinery.com) for a list of service centers or call the DELTA Machinery help line at 1-800-223-7278 (In Canada call 1-800-463-3582).

## MAINTENANCE

### KEEP MACHINE CLEAN

Periodically blow out all air passages with dry compressed air. All plastic parts should be cleaned with a soft damp cloth. NEVER use solvents to clean plastic parts. They could possibly dissolve or otherwise damage the material.

**⚠ WARNING** Wear ANSI Z87.1 safety glasses while using compressed air.

### FAILURE TO START

Should your machine fail to start, check to make sure the prongs on the cord plug are making good contact in the outlet. Also, check for blown fuses or open circuit breakers in the line.

## SERVICE



## PARTS, SERVICE OR WARRANTY ASSISTANCE

All Delta Machines and accessories are manufactured to high quality standards and are serviced by a network of Porter-Cable • Delta Factory Service Centers and Delta Authorized Service Stations. To obtain additional information regarding your Delta quality product or to obtain parts, service, warranty assistance, or the location of the nearest service outlet, please call 1-800-223-7278 (In Canada call 1-800-463-3582).

## ACCESSORIES

A complete line of accessories is available from your Delta Supplier, Porter-Cable • Delta Factory Service Centers, and Delta Authorized Service Stations. Please visit our Web Site [www.deltamachinery.com](http://www.deltamachinery.com) for a catalog or for the name of your nearest supplier.

**⚠ WARNING** Since accessories other than those offered by Delta have not been tested with this product, use of such accessories could be hazardous. For safest operation, only Delta recommended accessories should be used with this product.

## WARRANTY



### Two Year Limited New Product Warranty

Delta will repair or replace, at its expense and at its option, any new Delta machine, machine part, or machine accessory which in normal use has proven to be defective in workmanship or material, provided that the customer returns the product prepaid to a Delta factory service center or authorized service station with proof of purchase of the product within two years and provides Delta with reasonable opportunity to verify the alleged defect by inspection. For all refurbished Delta product, the warranty period is 180 days. Delta may require that electric motors be returned prepaid to a motor manufacturer's authorized station for inspection and repair or replacement. Delta will not be responsible for any asserted defect which has resulted from normal wear, misuse, abuse or repair or alteration made or specifically authorized by anyone other than an authorized Delta service facility or representative. Under no circumstances will Delta be liable for incidental or consequential damages resulting from defective products. This warranty is Delta's sole warranty and sets forth the customer's exclusive remedy, with respect to defective products; all other warranties, express or implied, whether of merchantability, fitness for purpose, or otherwise, are expressly disclaimed by Delta.

# NOTES

## PORTER-CABLE • DELTA SERVICE CENTERS (CENTROS DE SERVICIO DE PORTER-CABLE • DELTA)

Parts and Repair Service for Porter-Cable • Delta Machinery are Available at These Locations  
(Obtenga Refaccion de Partes o Servicio para su Herramienta en los Siguients Centros de Porter-Cable • Delta)

### ARIZONA

Phoenix 85013-2906  
4501 N. 7th Ave.  
Phone: (602) 279-6414  
Fax: (602) 279-5470

### CALIFORNIA

Ontario 91761 (Los Angeles)  
3949A East Guasti Road  
Phone: (909) 390-5555  
Fax: (909) 390-5554

San Diego 92111  
7290 Clairemont Mesa Blvd.  
Phone: (858) 279-2011  
Fax: (858) 279-0362

San Leandro 94577 (Oakland)  
3039 Teagarden Street  
Phone: (510) 357-9762  
Fax: (510) 357-7939

### COLORADO

Denver 80223  
700 West Mississippi Ave.  
Phone: (303) 922-8325  
Fax: (303) 922-0245

### FLORIDA

Davie 33314 (Miami)  
4343 South State Rd. 7 (441)  
Unit #107  
Phone: (954) 321-6635  
Fax: (954) 321-6638

Tampa 33634  
4909 West Waters Ave.  
Phone: (813) 884-0434  
Fax: (813) 888-5997

### GEORGIA

Forest Park 30297 (Atlanta)  
5442 Frontage Road,  
Suite 112  
Phone: (404) 608-0006  
Fax: (404) 608-1123

### ILLINOIS

Addison 60101 (Chicago)  
400 South Rohlwing Rd.  
Phone: (630) 424-8805  
Fax: (630) 424-8895

### KANSAS

Overland Park 66214  
9201 Quivira Road  
Phone: (913) 495-4330  
Fax: (913) 495-4378

### MARYLAND

Elkridge 21075 (Baltimore)  
7397-102 Washington Blvd.  
Phone: (410) 799-9394  
Fax: (410) 799-9398

### MASSACHUSETTS

Franklin 02038 (Boston)  
Franklin Industrial Park  
101E Constitution Blvd.  
Phone: (508) 520-8802  
Fax: (508) 528-8089

### MICHIGAN

Madison Heights 48071 (Detroit)  
30475 Stephenson Highway  
Phone: (248) 597-5000  
Fax: (248) 597-5004

### MINNESOTA

Eden Prairie 55344  
9709 Valley View Road  
Phone: (952) 884-9191  
Fax: (952) 884-3750

### MISSOURI

St. Louis 63146  
11477 Page Service Drive  
Phone: (314) 997-9100  
Fax: (314) 997-9183

### NEW YORK

Flushing 11365-1595 (N.Y.C.)  
175-25 Horace Harding Expwy.  
Phone: (718) 225-2040  
Fax: (718) 423-9619

### NORTH CAROLINA

Charlotte 28270  
9129 Monroe Road, Suite 115  
Phone: (704) 841-1176  
Fax: (704) 708-4625

### OHIO

Columbus 43229  
1948 Schrock Road  
Phone: (614) 895-3112  
Fax: (614) 895-3187

Parma Heights OH 44130  
6485 Pearl Road  
Phone: (440) 842-9100  
Fax: (440) 884-3430

### OREGON

Portland 97230  
14811 North East Airport Way  
Phone: (503) 255-6556  
Fax: (503) 255-6543

### PENNSYLVANIA

Willow Grove 19090  
(Philadelphia)  
520 North York Road  
Phone: (215) 658-1430  
Fax: (215) 658-1433

### TEXAS

Carrollton 75006 (Dallas)  
1300 Interstate 35 N, Suite 112  
Phone: (972) 446-2996  
Fax: (972) 446-8157

### Houston 77022-2122

536 East Tidwell Rd.  
Phone: (713) 692-7111  
Fax: (713) 692-1107

### WASHINGTON

Auburn 98001(Seattle)  
3320 West Valley HWY, North  
Building D, Suite 111  
Phone: (253) 333-8353  
Fax: (253) 333-9613

Authorized Service Stations are located in many large cities. Telephone **800-438-2486** or **731-541-6042** for assistance locating one. Parts and accessories for Porter-Cable-Delta products should be obtained by contacting any Porter-Cable-Delta Distributor, Authorized Service Center, or Porter-Cable-Delta Factory Service Center. If you do not have access to any of these, call **800-223-7278** and you will be directed to the nearest Porter-Cable-Delta Factory Service Center. Las Estaciones de Servicio Autorizadas están ubicadas en muchas grandes ciudades. Llame al **800-438-2486** ó al **731-541-6042** para obtener asistencia a fin de localizar una. Las piezas y los accesorios para los productos Porter-Cable-Delta deben obtenerse poniéndose en contacto con cualquier distribuidor Porter-Cable-Delta, Centro de Servicio Autorizado o Centro de Servicio de Fábrica Porter-Cable-Delta. Si no tiene acceso a ninguna de estas opciones, llame al **800-223-7278** y le dirigirán al Centro de Servicio de Fábrica Porter-Cable-Delta más cercano.

## CANADIAN PORTER-CABLE • DELTA SERVICE CENTERS

### ALBERTA

Bay 6, 2520-23rd St. N.E.  
Calgary, Alberta  
T2E 8L2  
Phone: (403) 735-6166  
Fax: (403) 735-6144

### BRITISH COLUMBIA

8520 Baxter Place  
Burnaby, B.C.  
V5A 4T8  
Phone: (604) 420-0102  
Fax: (604) 420-3522

### MANITOBA

1699 Dublin Avenue  
Winnipeg, Manitoba  
R3H 0H2  
Phone: (204) 633-9259  
Fax: (204) 632-1976

### ONTARIO

505 Southgate Drive  
Guelph, Ontario  
N1H 6M7  
Phone: (519) 767-4132  
Fax: (519) 767-4131

### QUÉBEC

1515 ave.  
St-Jean Baptiste, Suite 160  
Québec, Québec  
G2E 5E2  
Phone: (418) 877-7112  
Fax: (418) 877-7123

1447, Begin  
St-Laurent, (Montréal),  
Québec  
H4R 1V8  
Phone: (514) 336-8772  
Fax: (514) 336-3505

The following are trademarks of PORTER-CABLE • DELTA (Las siguientes son marcas registradas de PORTER-CABLE • DELTA S.A.) (Les marques suivantes sont des marques de fabricant de la PORTER-CABLE • DELTA): Auto-Set<sup>®</sup>, BAMMER<sup>®</sup>, B.O.S.S.<sup>®</sup>, Builder's Saw<sup>®</sup>, Contractor's Saw<sup>®</sup>, Contractor's Saw II<sup>™</sup>, Delta<sup>®</sup>, DELTACRAFT<sup>®</sup>, DELTAGRAM<sup>™</sup>, Delta Series 2000<sup>™</sup>, DURATRONIC<sup>™</sup>, Emc<sup>2™</sup>, FLEX<sup>®</sup>, Flying Chips<sup>™</sup>, FRAME SAW<sup>®</sup>, Grip Vac<sup>™</sup>, Homecraft<sup>®</sup>, INNOVATION THAT WORKS<sup>®</sup>, Jet-Lock<sup>®</sup>, JETSTREAM<sup>®</sup>, 'kickstand<sup>®</sup>, LASERLOC<sup>®</sup>, MICRO-SET<sup>®</sup>, Micro-Set<sup>®</sup>, MIDI LATHE<sup>®</sup>, MORTEN<sup>™</sup>, NETWORK<sup>™</sup>, OMNIJIG<sup>®</sup>, POCKET CUTTER<sup>®</sup>, PORTA-BAND<sup>®</sup>, PORTA-PLANE<sup>®</sup>, PORTER-CABLE<sup>®</sup>&(design), PORTER-CABLE<sup>®</sup>PROFESSIONAL POWER TOOLS, PORTER-CABLE REDEFINING PERFORMANCE<sup>™</sup>, Posi-Matic<sup>®</sup>, Q-3<sup>®</sup>&(design), QUICKSAND<sup>®</sup>&(design), QUICKSET<sup>™</sup>, QUICKSET II<sup>®</sup>, QUICKSET PLUS<sup>™</sup>, RIPTIDE<sup>™</sup>&(design), SAFE GUARD II<sup>®</sup>, SAFE-LOC<sup>®</sup>, Sanding Center<sup>®</sup>, SANDTRAP<sup>®</sup>&(design), SAW BOSS<sup>®</sup>, Sawbuck<sup>™</sup>, Sidekick<sup>®</sup>, SPEED-BLOC<sup>®</sup>, SPEEDMATIC<sup>®</sup>, SPEEDTRONIC<sup>®</sup>, STAIR EASE<sup>®</sup>, The American Woodshop<sup>®</sup>&(design), The Lumber Company<sup>®</sup>&(design), THE PROFESSIONAL EDGE<sup>®</sup>, THE PROFESSIONAL SELECT<sup>®</sup>, THIN-LINE<sup>™</sup>, TIGER<sup>®</sup>, TIGER CUB<sup>®</sup>, TIGER SAW<sup>®</sup>, TORQBUSTER<sup>®</sup>, TORQ-BUSTER<sup>®</sup>, TRU-MATCH<sup>™</sup>, TWIN-LITE<sup>®</sup>, UNIGUARD<sup>®</sup>, Unifence<sup>®</sup>, UNIFEEDER<sup>™</sup>, Unihead<sup>®</sup>, Uniplane<sup>™</sup>, Unirip<sup>®</sup>, Unisaw<sup>®</sup>, Univise<sup>®</sup>, Versa-Feeder<sup>®</sup>, VERSA-PLANE<sup>®</sup>, WHISPER SERIES<sup>®</sup>, WOODWORKER'S CHOICE<sup>™</sup>.

Trademarks noted with <sup>™</sup> and <sup>®</sup> are registered in the United States Patent and Trademark Office and may also be registered in other countries. Las Marcas Registradas con el signo de <sup>™</sup> y <sup>®</sup> son registradas por la Oficina de Registros y Patentes de los Estados Unidos y también pueden estar registradas en otros países.

PC7.2-0105-149



## Free Manuals Download Website

<http://myh66.com>

<http://usermanuals.us>

<http://www.somanuals.com>

<http://www.4manuals.cc>

<http://www.manual-lib.com>

<http://www.404manual.com>

<http://www.luxmanual.com>

<http://aubethermostatmanual.com>

Golf course search by state

<http://golfingnear.com>

Email search by domain

<http://emailbydomain.com>

Auto manuals search

<http://auto.somanuals.com>

TV manuals search

<http://tv.somanuals.com>