

**Hamilton Beach®**

*Open Ease™ Can Opener*

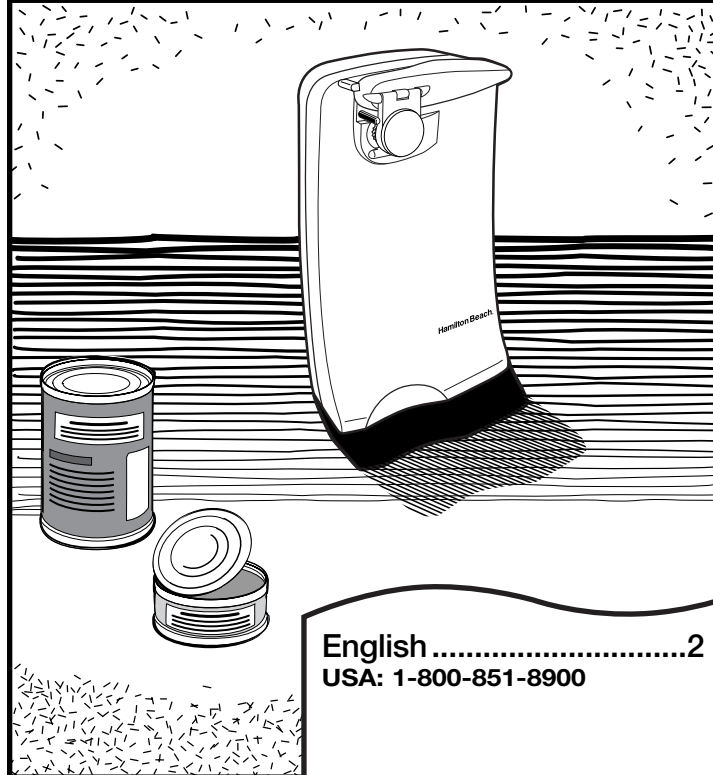

English .....2  
USA: 1-800-851-8900

840064900

## *Can Opener Safety*

### **IMPORTANT SAFEGUARDS**

When using electrical appliances, basic safety precautions should always be followed, including the following:

1. Read all instructions.
2. To protect against risk of electrical shock, do not put can opener body, cord, or plug in water or other liquid.
3. Close supervision is necessary when any appliance is used by or near children.
4. Unplug from outlet when not in use, before putting on or taking off parts, and before cleaning.
5. Avoid contacting moving parts.
6. Do not operate any appliance with a damaged cord or plug, or after the appliance malfunctions or is dropped or damaged in any manner. Call our toll-free customer service number for information on examination, electrical repair, mechanical repair, or adjustment. No user serviceable parts inside.
7. The use of attachments not recommended or sold by Hamilton Beach/Proctor-Silex, Inc. may cause fire, electric shock, or injury.
8. Do not use outdoors.
9. Do not let cord hang over edge of table or counter, or touch hot surfaces.
10. Do not place on or near a hot gas or electric burner, or in a heated oven.
11. Do not open pressurized (aerosol-type) cans.
12. Do not open cans of flammable liquids such as lighter fluid.
13. Do not use appliance for other than intended use.

### **SAVE THESE INSTRUCTIONS**

### **CONSUMER SAFETY INFORMATION**

**This appliance is intended for household use only.**

This appliance is equipped with a polarized plug. This type of plug has one blade wider than the other. The plug will fit into an electrical outlet only one way. This is a safety feature intended to help reduce the risk of electrical shock. If you are unable to insert the plug into the outlet, try reversing the plug. If the plug should still fail to fit, contact a qualified electrician to replace the obsolete outlet. Do not attempt to defeat the safety purpose of the polarized plug by modifying the plug in any way.

The length of the cord used on this appliance was selected to reduce the hazards of becoming tangled in, or tripping over a longer cord. If a longer cord is necessary an approved extension cord may be used. The electrical rating of the extension cord must be equal to or greater than the rating of the can opener. Care must be taken to arrange the extension cord so that it will not drape over the counter-top or tabletop where it can be pulled on by children or accidentally tripped over.

**WARNING:** To reduce the risk of personal injury, keep hair and loose clothing away from lid opener and other moving parts of the can opener while using.

## Know Your Can Opener

1. Can Guide
2. Piercing Lever
3. Geared Wheel

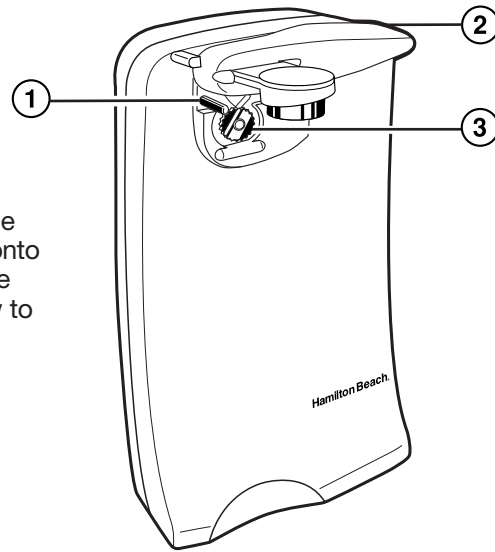

**NOTE:** To assemble the piercing lever onto the can opener, see Step 5 in the “How to Clean” section.

4

## How to Use Your Can Opener

1. Place can opener on level surface.
2. Plug cord into electrical outlet.
3. Raise piercing lever up.
4. Place rim of can firmly under can guide and against geared wheel.
5. Tilt top of can in, to position the cutting blade inside the rim of the can.
6. Press piercing lever all the way down.
7. The motor will begin turning can and cutting lid. (It is not necessary to hold the piercing lever down or to hold the can during the cutting action.)
8. The motor will automatically stop when the can is open.
9. Remove can from can opener and check can contents to remove any pieces of label or metal shavings.

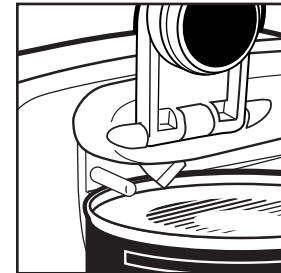

(Use the flip-up magnet to easily see can position.)

5

## *How to Clean Your Can Opener*

1. Unplug cord from electrical outlet.
2. To remove the piercing lever, push lever up and to the left. It will pop out of a locked position.
3. Wash the piercing lever in hot, soapy water. Rinse and dry thoroughly. Do not place in dishwasher.
4. Wipe the body of can opener with damp cloth. NEVER immerse the can opener in water.
5. To assemble, place the knob on the back of piercing lever into large end of keyhole with the lever pointing toward the ceiling. Push the lever to the left until it locks into place.

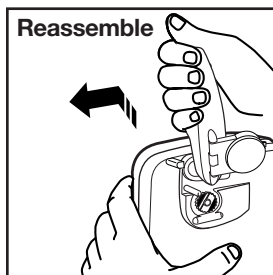
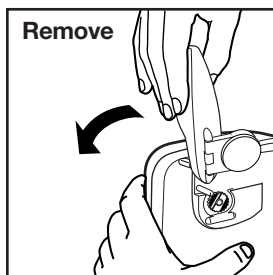

## **Hints for Best Use**

- The can opener will easily open all standard size cans.
- On some models it will be necessary to position can opener at edge of counter, allowing for clearance to open cans taller than the can opener.
- If there is a bump, dent, or heavy seam in the rim of the can, open the other end of the can or start cutter just beyond the problem area.
- The motor of your can opener is permanently lubricated and will require no oiling.
- To use the cord storage on the back of the opener, push in or pull out the cord as needed.

## *Sharpening Knives*

1. Place cutting edge of knife in the knife slot located on the back of the can opener.
2. Draw the knife blade through the slot several times.

**NOTE:** Serrated blades should never be inserted into this unit.

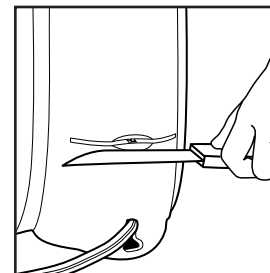

## *Customer Service/Warranty*

If you have a question about your can opener, call our toll-free customer service number. Before calling, please note the model, type, and series numbers and fill in that information below. These numbers can be found on the bottom of your can opener. This information will help us answer your question much more quickly.

**MODEL:** \_\_\_\_\_ **TYPE:** \_\_\_\_\_ **SERIES:** \_\_\_\_\_

### **TWO YEAR LIMITED WARRANTY**

Hamilton Beach/Proctor-Silex, Inc. warrants this appliance to be free from defects in material and workmanship for a period of two (2) years from the date of original purchase, except as noted. There is no warranty with respect to the following, which may be supplied with this appliance: glass parts, glass containers, cutter/strainer, blades and/or agitators. This warranty extends only to the original consumer purchaser and does not cover damage from abuse, neglect, use for commercial purposes, or any other use not found in the printed directions. HAMILTON BEACH/PROCTOR-SILEX, INC. EXPRESSLY DISCLAIMS ALL RESPONSIBILITY FOR CONSEQUENTIAL DAMAGES OR INCIDENTAL LOSSES CAUSED BY USE OF THIS APPLIANCE. Some states or provinces do not allow this exclusion or limitation of incidental or consequential losses, so the foregoing disclaimer may not apply to you. If you have a claim under this warranty, DO NOT RETURN THE APPLIANCE TO THE STORE! Please call our CUSTOMER SERVICE NUMBER. (For faster service please have model and serial numbers ready for operator to assist you.)

### **CUSTOMER SERVICE NUMBERS**

In the U.S. 1-800-851-8900

In Canada 1-800-267-2826

**Web site address: [www.hamiltonbeach.com](http://www.hamiltonbeach.com)**

**KEEP THESE NUMBERS FOR FUTURE REFERENCE!**

This warranty gives you specific legal rights, and you may also have other legal rights which vary from state to state, or province to province.

**HAMILTON BEACH ♦ PROCTOR-SILEX, INC.**

Washington, North Carolina 27889

**PROCTOR-SILEX CANADA, INC.**

Picton, Ontario K0K 2T0

840064900

Web site address: [www.hamiltonbeach.com](http://www.hamiltonbeach.com)

12/99

## Free Manuals Download Website

<http://myh66.com>

<http://usermanuals.us>

<http://www.somanuals.com>

<http://www.4manuals.cc>

<http://www.manual-lib.com>

<http://www.404manual.com>

<http://www.luxmanual.com>

<http://aubethermostatmanual.com>

Golf course search by state

<http://golfingnear.com>

Email search by domain

<http://emailbydomain.com>

Auto manuals search

<http://auto.somanuals.com>

TV manuals search

<http://tv.somanuals.com>